

magic



Magic lighting solutions

Technik für Möbel

Hettich

Hettich Australia

1 Herbert Place
Smithfield NSW 2164

Phone 02 96167700
Free phone 1800 HETTICH
Fax 02 96167778

hettich.com.au

Hettich New Zealand

18 Barmac Place
East Tamaki Auckland

Phone 09 2747374
Free phone 0800 HETTICH
Fax 09 2747847

hettich.co.nz

© Hettich FurnTech GmbH & Co. KG
32602 Vlotho · Germany

We reserve all rights to this catalogue under copyright law. It shall not be permissible to duplicate this catalogue in any form either in whole or in part without our written consent. Subject to technical alterations. Errors and omissions excepted. Subject to colour variations.

2012
Order no. 9 139 356

Contents

Lighting effects	1
Cooking with light	2 – 7
Playing with light	8 – 9
Living with light	10 – 11
Relaxing with light	12 – 13
Pampering with light	14 – 15
Working with light	16 – 17
Product range	
Task lighting	18 – 41
Mood lighting	42 – 67
Accessories	68 – 84
Test marks and symbols	85
Lighting basics	86 – 87
Subject index	88
Product index	89

Lighting effects



Making living spaces work beautifully

The way we perceive an object or environment largely depends on the lighting situation. Does a space look interesting or monotonous, inviting or oppressive, homely or sober? Light defines the mood and can be used to create a personal feel. Light can make a space look bigger or upgrade its practical and aesthetic value.

Define your furniture and room features with the sensitive power of light. Transform nondescript rooms into vibrant living spaces. Magic lights give you all the options with compact, energy-saving LEDs you can discreetly integrate into furniture and intelligent lighting control that conjures the perfect feel-good ambience at the press of a button. Magic lighting offers a range of functions to cater to your customers' every lighting need.



▲ Task lighting pages 18 – 41

Practical, cool white light is ideal for the kitchen work zone. This is best for bringing out colours and fine structures, such as in food. Magic lights can be discreetly installed in wall units directly above the work surface. This provides homogeneous, non-glaring illumination.



▲ Mood lighting pages 42 – 67

One room, two moods. The dining table is bathed in gentle light for a leisurely dinner. It forms the centre of the room. In the background, mood lighting creates a captivating sense of depth.



There's no recipe for life. But there is for lighting using Magic.

Cooking for friends, enjoying time together at the table. Then later on, philosophical discussions over a glass of wine. The kitchen is the heart of the home. Give yours the perfect light - with Magic from Hettich.



Illustrious circles:
lighting turns the shelf into a stage.
Swing. Page 30



A picture of light. With a flexible LED
band behind the frame, the picture
appears to float.
Versa SideView. Page 52



Shelves revamped. Attractive design
effects from backlit glass shelves.
GlasLine. Page 58



Why feel around for plates in the dark when there's Magic? Obvious, really.
Race. Page 24

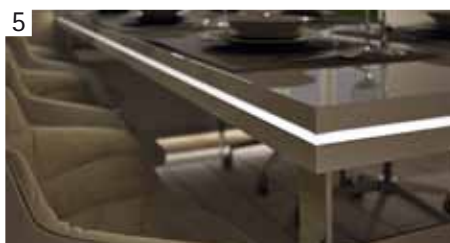

Lines of light. LED technology makes astonishing statements.
Versa in ChannelLine 1. Pages 44, 54



Nice and bright during the day.
Subdued in the evening.

The work zone in a kitchen demands bright, neutral light. Then when everything's done, that's when your Magic lighting concept transforms your kitchen into a living space of atmosphere – with an elegant and prestigious feel.



1
When light from outside fails,
LooLite lights up the windows.
LooLite. Page 28



2
Shining light: Magic helps your
designer objects to steal the show.
SuperNovara. Page 22



3
Even when things get tight,
there's always room for LooLite.
LooLite. Page 28



4 Little effort, big effect. Concealed LED strip in the plinth.
Versa. Page 44



5 Turns everyday items into showpieces: LooLite under the sink.
LooLite. Page 28



6 Hard to believe: The family has lunch from these designer objects.
Spot in Plus. Page 62



Modern lighting for designer spaces. Task to mood with the flick of a switch.

When traditional kitchen solutions no longer work for you, design with Magic. Work areas are illuminated with practical, shadow-free light, while in remote corners, lighting effects create a beautiful ambience.



Drawer open, light on! So you don't have to search around for long.
InnoLine. Page 40



Striking feature: LED lighting strips in the dining table.
Versa in ChannelLine 1. Pages 44, 54





Kids want cool lighting.

LED lights not only look cool, they are cool, quite literally. LEDs generate a lot of light but very little heat. This makes them ideal for children's and teenager's rooms. Magic lights are perfect for homework, chatting and chilling – always in the right light.



Spotlight on the shelf, showing everyday life from the brightest side. BriteSquare L. Page 34



As mystical as a galactic lightsabre: the LED band is master of all colours. Versa Inside MultiColor in ChannellLine 1. Pages 50, 54



Magic lights cut an attractive figure, particularly in the wardrobe. Versa Inside I in ChannellLine 10 combined with door contact switch. Pages 46, 57



4
Illuminating insight: InnoLine sheds a clear light even in drawers.
InnoLine. Page 40



5
Ready for an Oscar. This puts DVDs on centre stage. Lights on!
Spot in Plus. Page 62



Light for feeling good.

The variety of life centres on the living room. Reading and relaxing, watching television and partying, chatting and forging plans all belong in the living room. Light follows any mood at the press of a button. With Mood lighting, atmosphere and brightness in the right place.



Sheer delight in beautiful architecture: lighting strips emphasise the formal charm of coving.

Versa Inside I. Page 46



Plenty of light where it's needed. Nice and bright but not glary. Briteline with door contact switch. Pages 26, 75



Frame of light: the best thing to illuminate pictures.

Versa SideView. Page 52



Making a powerful impact with your furniture ideas: LEDs with an ultra-flat profile as design elements.
Versa in ChannellLine 3. Pages 44, 55



And this is where you are the lighting director, with swivelling spots from Magic.
Swing. Page 30



The best video store is now at home, perfectly illuminated.
Versa Inside I in ChannellLine 10.
Pages 46, 57



Sleep well with subtle lighting in the bedroom

The bedroom is the home's haven of peace. Non-glaring, warm light lets the day end in harmony. Without impeding the production of sleep hormone melatonin, subtle lighting helps to give you a good night's sleep.

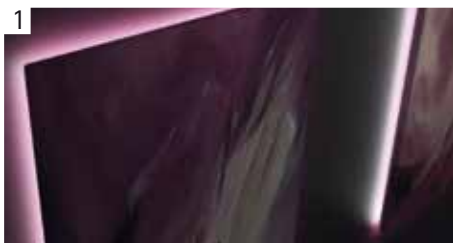

Picture tweaking Magic style sets off pictures beautifully providing gentle light.
Versa SideView. Page 52



Heavenly lighting: Above the trim panel, LED lighting strips provide gentle uplighting.
Versa Inside I. Page 46



Control of the lights at your fingertips: a gentle touch is all it needs.
Tri-Mitter. Page 72



Light and airy: the gentle light from the mini LEDs brings radiance to the glass edge.

GlasLine. Page 58



A fringe of light gives a shining example of creative furniture design.

Versa in ChannelLine 1. Pages 44, 54



Complementary good lighting

The bathroom is the sanctuary for secluded luxury at home, a place to refresh before facing the day. Then, at the end of the day, the bathroom is a space for nurturing and restoring, pampering and soothing. Magic offers lighting for performing tasks or setting the mood.

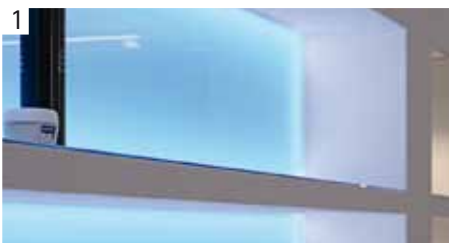

As blue as the sea, as green as the lagoon, as red as the reef. Coming to your bathroom soon.

Versa Inside MultiColor. Page 50



Delicate LED band with dimmer. For pleasantly soft light.

Versa Inside I in ChannelLine 1.

Pages 46, 54



Private beauty parlour: pure-white LEDs make colours look natural.

Pady. Page 20



Refreshing lighting ideas put the bathroom in a good mood, and you as well. Versa in ChannelLine 1. Pages 44, 54



The only thing you won't find here is a light switch. Briteline with infrared door contact switch. Pages 26, 75



Make your workplace shine.

More and more people work from home. Your home office is where you have a say in design. So, here goes: bright lit shelves, indirect room light and vibrant statements – a compelling combination.



If you don't have time for the cinema, there's a cool film on here too. Versa in ChannellLine 1. Pages 44, 54



A wall, a shelf, a Magic spot. Conjuring lighting effects is as easy as this. Spot in Plus. Page 62



Books need good light. Even if you're not reading them. StarPoint. Page 60





Task Lighting

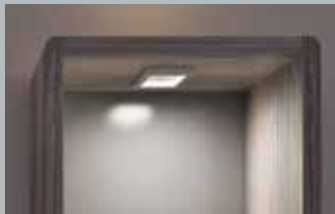

Pady
Pages 20–21
LED



SuperNovara
Pages 22–23
LED

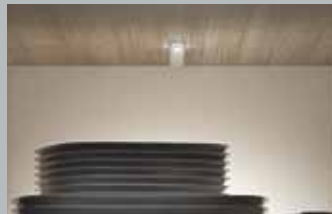

Race
Pages 24–25
LED



BriteLine
Pages 26–27
LED



LooLite
Pages 28–29
LED

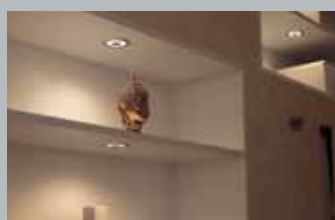

Swing
Pages 30–31
LED



Sign round
Pages 32–33
LED



BriteSquare L
Pages 34–35
LED



EcoPower
Pages 36–37
LED



LuckyInside
Pages 38–39
LED



InnoLine
Pages 40–41
LED

Task Lighting

- ▶ LED lights
- ▶ Pady



Light type	Recessed / Surface-mounting LED light
Illumination type	Task lighting
Surface finish	Aluminium look
Special feature	Superbly designed and powerful recessed light A 7" evenly illuminated area conjures a unique effect
Ordering information	LED ballast must be ordered separately, see below or refer to page 78



Light Distribution diagram / 65°

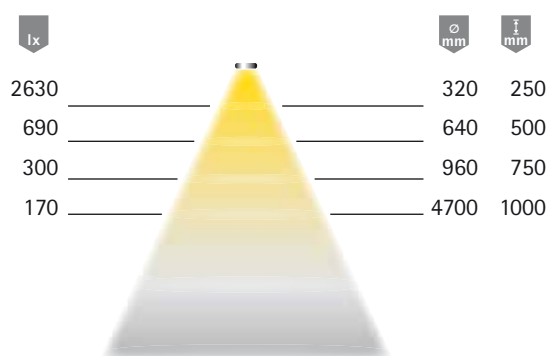

Technical details in brief

Operating voltage	12 Volt DC
Light tone	Cool white
Colour reproduction	
RA	> 80
Power consumption	7,5 W
Dimmable	No
Number of LEDs	1
Light emission angle	65°
Test marks and symbols	CE V V
IP rating	IP 20
Supply lead	2000 mm
Plug connection	LED mini plug connection M1
Connection to	LED ballast

Pady

Light Tone	Order No.	PU
Cool white	9 127 531	1 each

Accessories

Article	Order No.	PU
Housing for Pady	9 127 532	1 each
LED ballast 30 W	9 138 076	1 each
LED extension lead M1, 1800 mm	0 041 762	1 each

- LED lights
- Pady

Dimensional Drawing

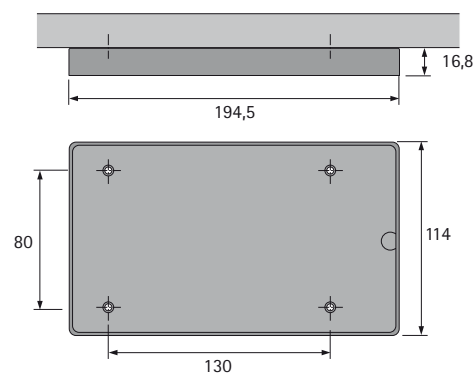
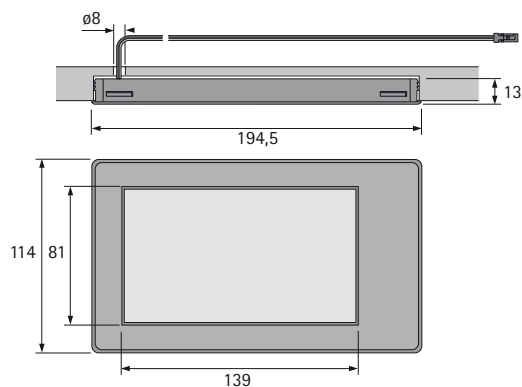

Assembly

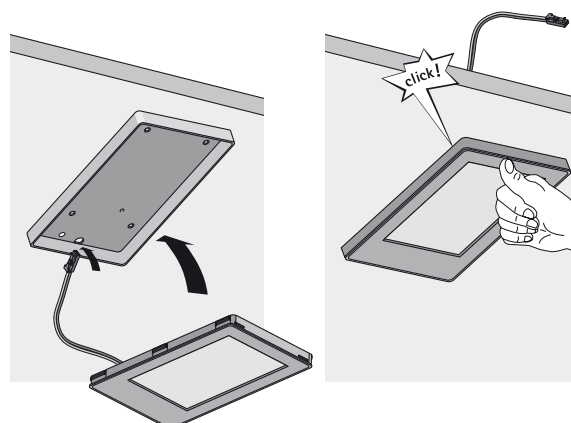
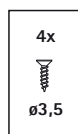
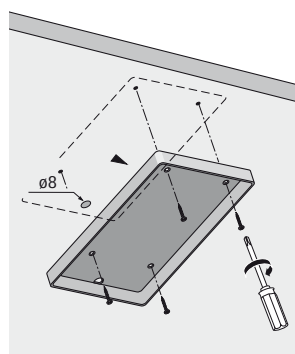
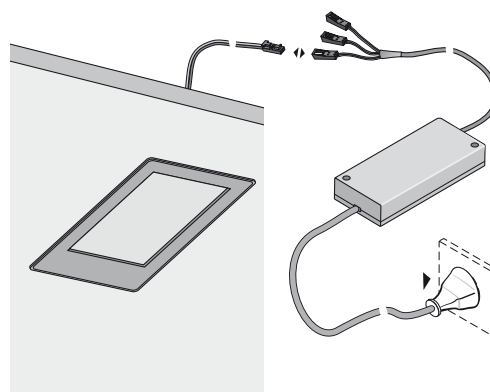
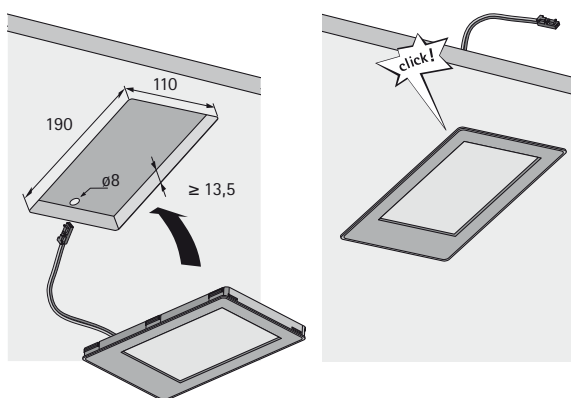

Task Lighting

- ▶ LED lights
- ▶ SuperNovara



Light type	Surface-mounting / top-mounting LED light
Illumination type	Task lighting
Surface finish	Stainless-steel look
Special feature	High-quality surface-mounting light providing virtually shadow-free illumination over a broad area
Ordering information	LED ballast must be ordered separately, see below or refer to page 78



Light Distribution diagram / 120°

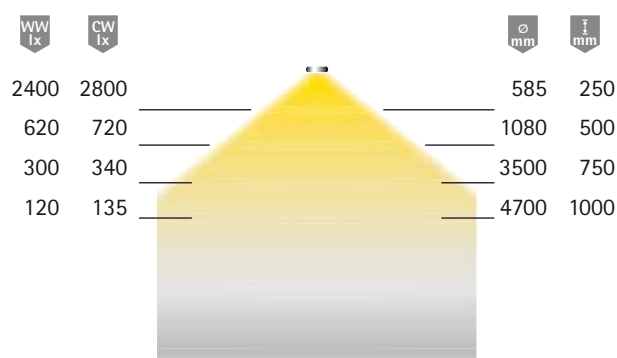

Technical details in brief

Operating voltage	12 Volt DC
Light tone	Warm white / Cool white
Colour reproduction	
RA	> 70
Power consumption	5,5 W
Dimmable	Yes
Number of LEDs	1
Light emission angle	120°
Test marks and symbols	CE
IP rating	IP 20
Supply lead	1700 mm
Plug connection	LED mini plug connection M1
Connection to	LED ballast

SuperNovara

Light Tone	Order No.	PU
Warm white	9 129 490	1 each
Cool white	9 129 491	1 each

Accessories

Article	Order No.	PU
LED ballast 30 W	9 138 076	1 each
LED extension lead M1, 1800 mm	0 041 762	1 each
6-way LED distributor M1, 2000 mm	9 084 272	1 each

Dimensional Drawing

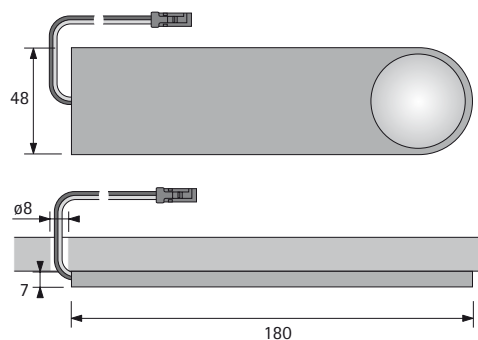

Assembly

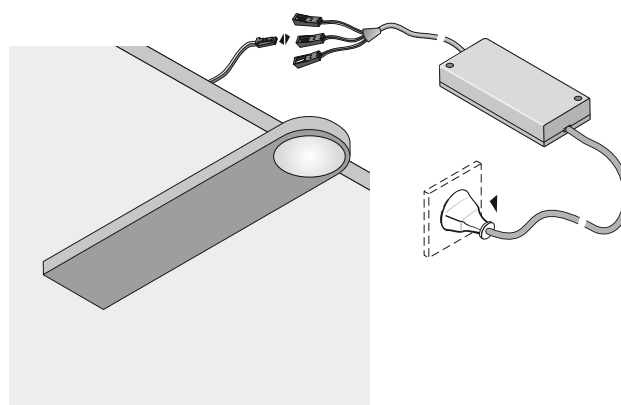
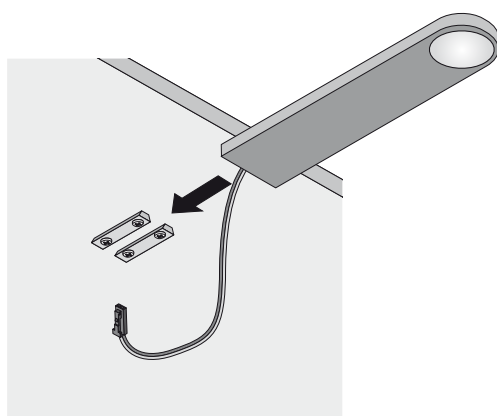
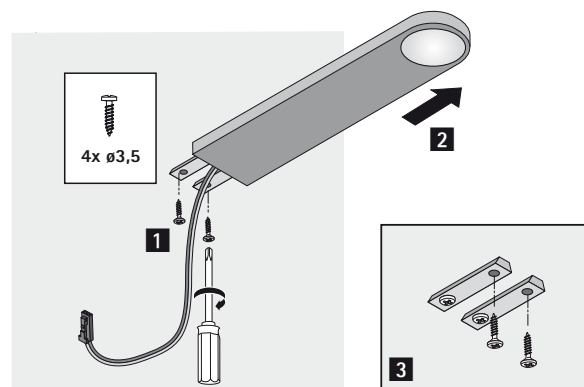
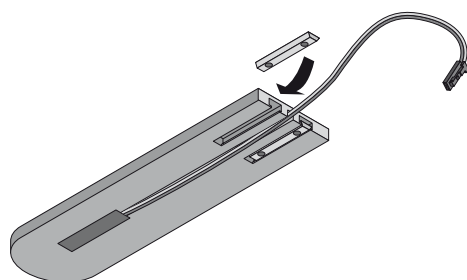

Task Lighting

- LED lights
- Race



Light type	Recessed / surface-mounting LED light
Illumination type	Task / mood lighting
Surface finish	Aluminium support profile with white plastic cover
Special feature	Powerful LED light with planar Power LED Ideal for use in kitchens midway sections, in wall units, glass cabinets and under shelves
Ordering information	LED ballast must be ordered separately, see below or refer to page 78



Light Distribution diagram / 62°

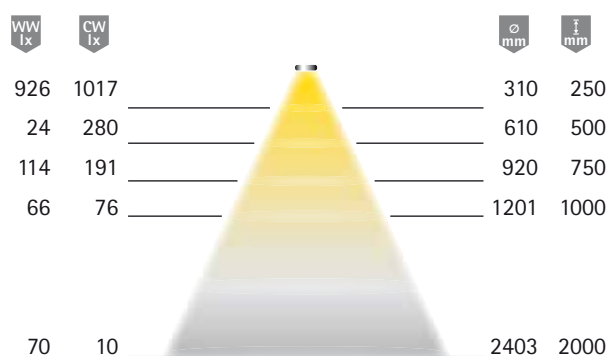

Technical details in brief

Operating voltage:	12 Volt DC
Light tone:	Warm white / Cool white
Colour reproduction	
RA:	> 60
Power consumption:	4,2 W
Dimmable:	Yes
Number of LEDs:	1
Light emission angle:	62°
Test marks and symbols:	CE V V V D GS
IP rating:	IP 20
Supply lead:	1700 mm
Plug connection:	LED mini plug connection M1
Connection to:	LED ballast

Race

Light Tone	Order No.	PU
Warm white	9 070 696	1 each
Cool white	9 070 181	1 each

Accessories

Article	Order No.	PU
Surface-mounting housing for Race, aluminium look	9 086 850	1 each
Surface-mounting housing for Race chrome-plated high-gloss	9 086 851	1 each
LED ballast 1,5 W - 15 W	9 098 453	1 each
LED extension lead M1, 1800 mm	0 041 762	1 each
6-way LED distributor M1, 2000 mm	9 084 272	1 each

Dimensional Drawing

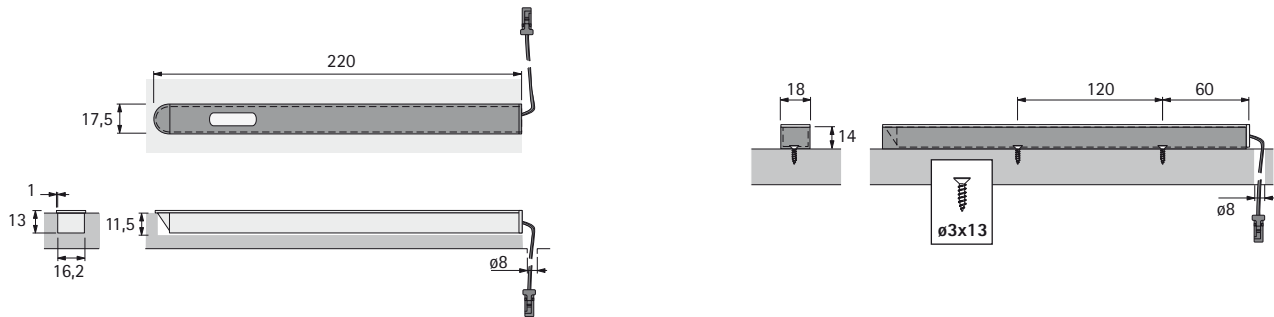

Assembly

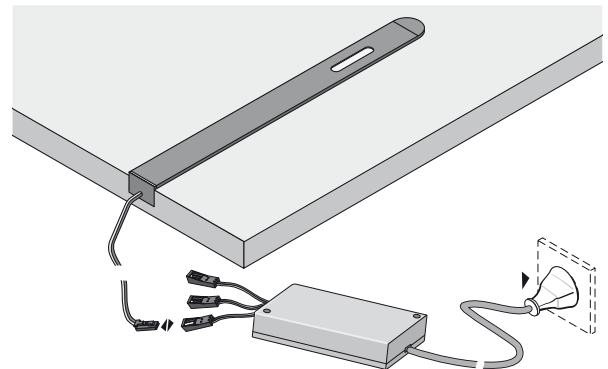
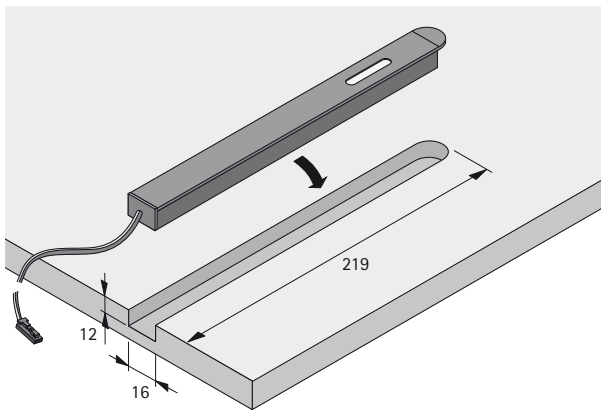

Task Lighting

- ▶ LED lights
- ▶ BriteLine



Light type	Recessed LED light
Illumination type	Task lighting
Surface finish	Brushed stainless-steel look
Special feature	Powerful recessed light for illuminating large areas Ideal for use in midway sections and over worktops
Ordering information	LED ballast must be ordered separately, see below or refer to page 78

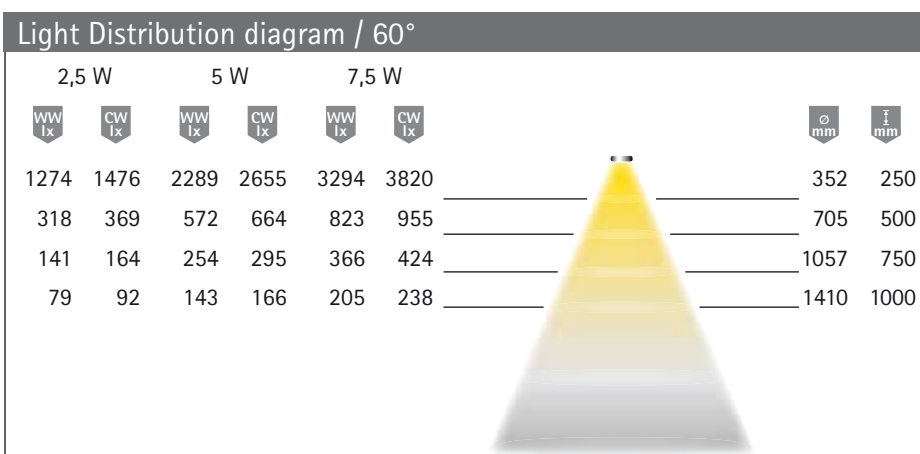

Technical details in brief

Operating voltage	12 Volt DC
Light tone	Warm white / Cool white
Colour reproduction	
RA	> 80 / > 70
Power consumption	2,5 W / 5 W / 7,5 W
Dimmable	Yes
Number of LEDs	9 / 18 / 27
Light emission angle	60°
Test marks and symbols	CE V V F
IP rating	IP 20
Supply lead	300 mm incl. 1700 mm extension lead
Plug connection	LED mini plug connection M1
Connection to	LED ballast

BriteLine

Length	Output	Order no. Warm white	Cool white	PU
100mm	2,5 W	9 128 396	9 128 397	1 each
240 mm	5 W	9 128 398	9 128 399	1 each
364 mm	7,5 W	9 128 400	9 128 481	1 each

Accessories

Article	Order No.	PU
LED ballast 15 W	9 098 453	1 each
LED ballast 30 W	9 138 076	1 each
LED extension lead M1, 1800 mm	0 041 762	1 each
6-way LED distributor M1, 2000 mm	9 084 272	1 each

- LED lights
- BriteLine

Dimensional Drawing

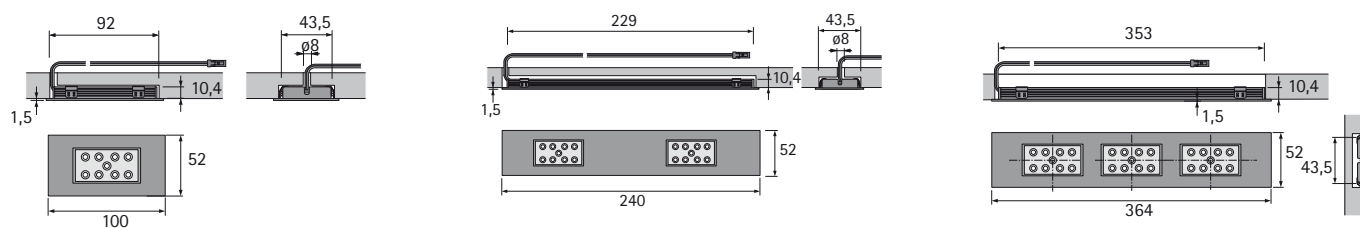

Assembly

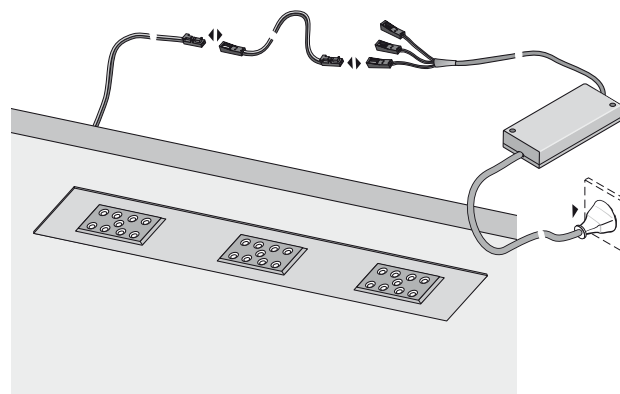
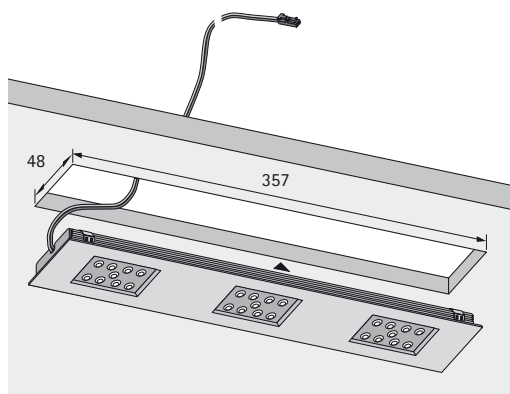
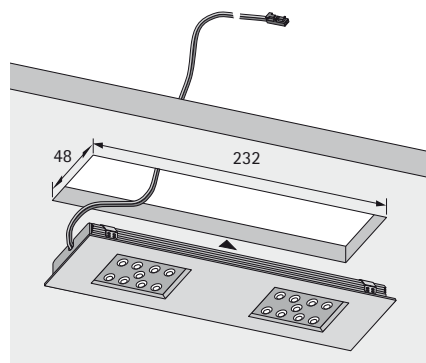
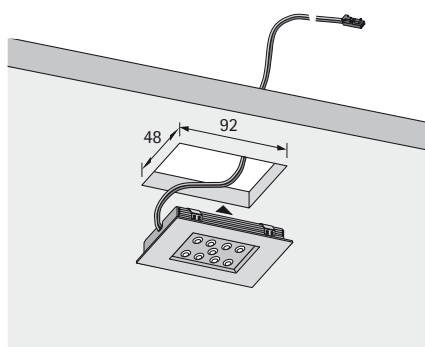

Task Lighting

- LED lights
- LooLite



Light type
Illumination type
Special feature
Ordering information

Recessed / surface-mounting LED light
Task lighting
LED light without dots.
LED ballast must be ordered separately, see below or refer to page 82
Also available as a set of 3 lights with LED Ballast, see below

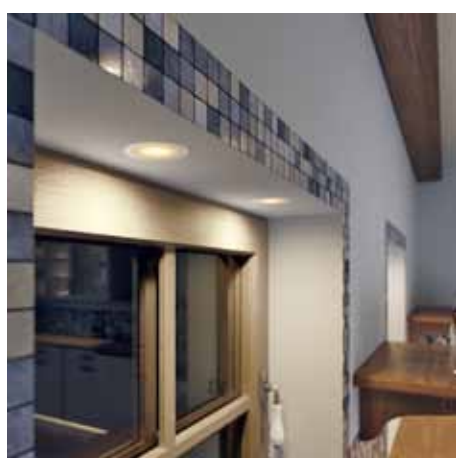

Light Distribution diagram / 60°

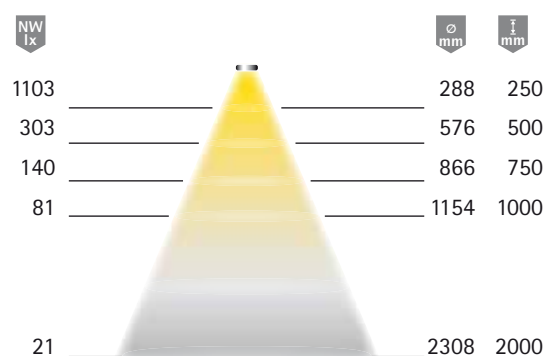

Technical details in brief

Operating current	350 mA
Light tone	Neutral white
Colour reproduction	
RA	> 80
Power consumption	3,5 W
Dimmable	Yes
Number of LEDs	1
Light emission angle	60°
Test marks and symbols	CE V V F D ENEC
IP rating	IP 20
Installed diameter	57-60 mm
Supply lead	300 mm incl. 1700 mm extension lead
Plug connection	LED mini plug connection M2
Connection to	LED ballast

LooLite

Surface finish	Order No.	PU
Stainless-steel look	9 129 440	1 each

Accessories

Article	Order No.	PU
Triangular housing for LooLite, stainless steel brushed	9 129 483	1 each
LED ballast 12 W 350 mA	9 138 077	1 each
LED extension lead M2, 1800 mm	9 130 680	1 each
3-way LED distributor M2, 180 mm	0 043 877	1 each

Sets

Set comprising: 3 LooLite
LED ballast 12 W 350 mA with 2000 mm supply lead

Light tone	Order No.	PU
Neutral white	9 139 151	1 each

Dimensional Drawing

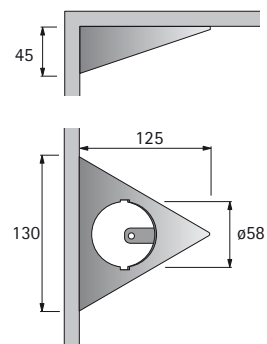
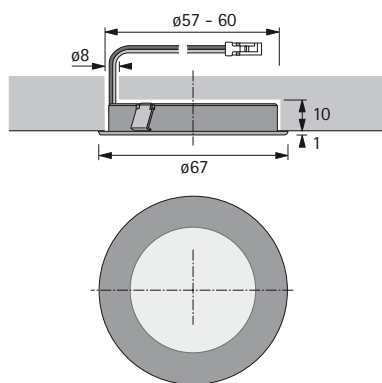

Assembly

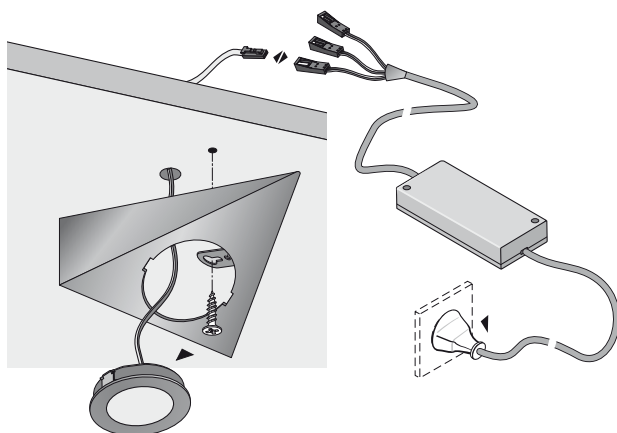
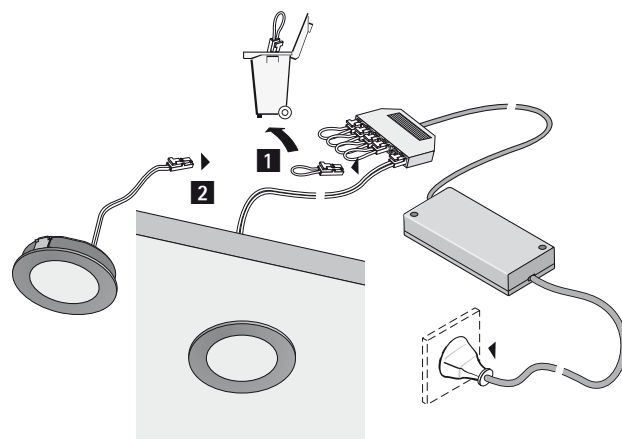
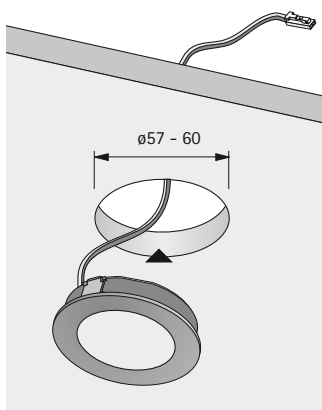

Task Lighting

- LED lights
- Swing



Light type	Recessed / surface-mounting LED light
Illumination type	Task / mood lighting
Surface finish	Aluminium support profile with white plastic cover
Special feature	LED light without light dots Tilting / turning designer light
Ordering information	LED ballast must be ordered separately, see below or refer to page 78

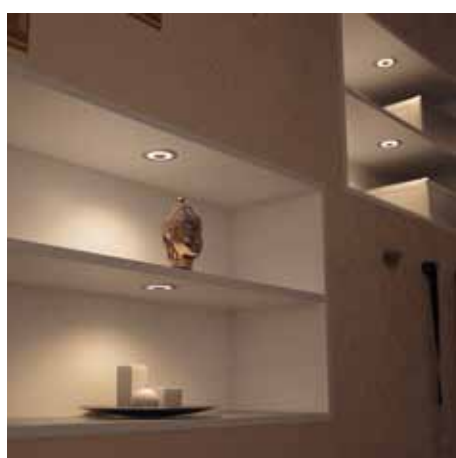

Light Distribution diagram / 50°

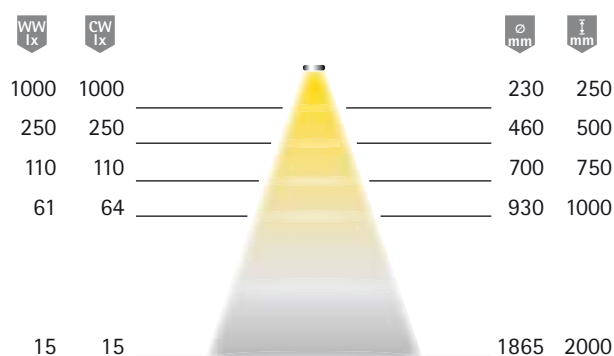

Technical details in brief

Operating voltage	12 Volt DC
Light tone	Warm white / Cool white
Power consumption	2,5 W
Dimmable	Yes
Number of LEDs	30
Light emission angle	50°
Test marks and symbols	CE W W
IP rating	IP 20
Installed diameter	68 mm
Supply lead	1700 mm
Plug connection	LED mini plug connection M1
Connection to	LED ballast

Swing

Light Tone	Order No.	PU
Warm white	9 127 517	1 each
Cool white	9 129 046	1 each

Accessories

Article	Order No.	PU
LED ballast 1,5 W – 15 W	9 098 453	1 each
LED extension lead M1, 1800 mm	0 041 762	1 each
6-way LED distributor M1, 2000 mm	9 084 272	1 each

Dimensional Drawing

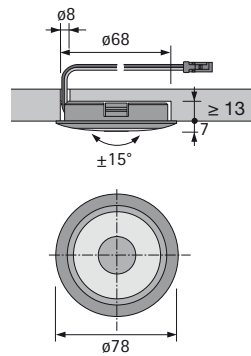

Assembly

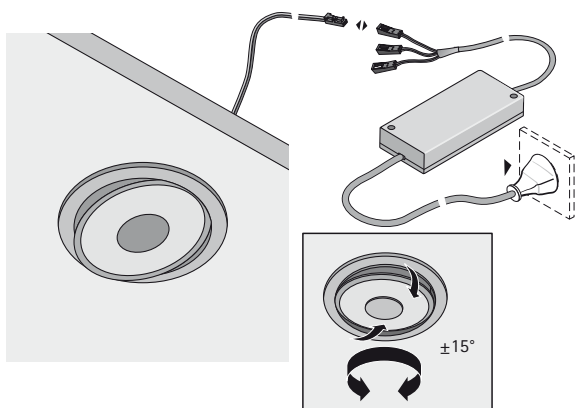
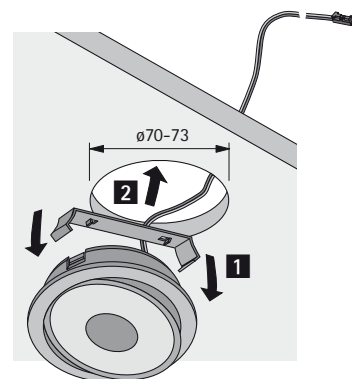
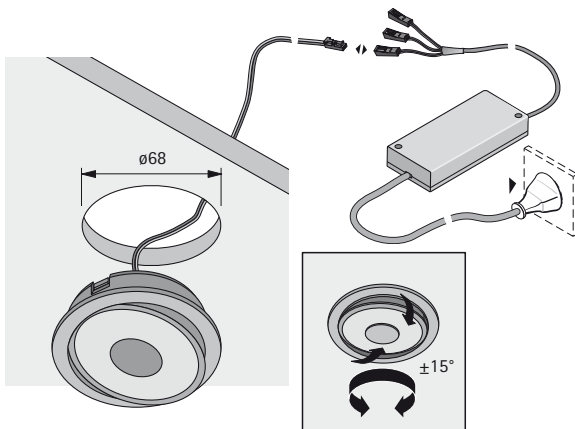

Task Lighting

- ▶ LED lights
- ▶ Sign round



Light type	Recessed / surface-mounting LED light
Illumination type	Task lighting
Surface finish	Aluminium support profile with white plastic cover
Special feature	Powerful recessed LED light with multi-chip Superflux LED Superb, even light distribution Ideal for use in kitchens midway sections, in wall units, glass cabinets and under shelves
Ordering information	LED ballast must be ordered separately, see below or refer to page 78 Also available as a set of 3 lights with LED ballast, see below



Light Distribution diagram / 52°

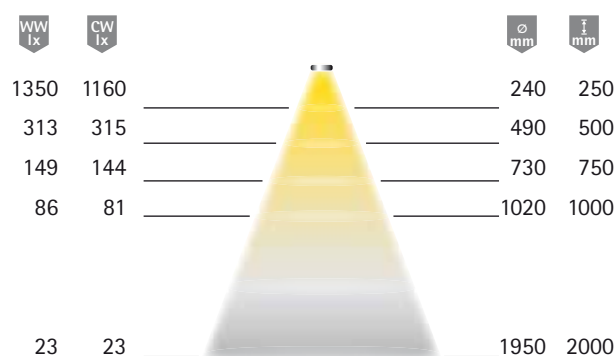

Technical details in brief

Operating voltage	12 Volt DC
Light tone	Warm white / Cool white
Colour reproduction	
RA	> 70
Power consumption	2,3 W
Dimmable	Yes
Number of LEDs	16
Light emission angle	52°
Test marks and symbols	CE V V V V V V V V
IP rating	IP 44
Installed diameter	68 mm
Supply lead	1700 mm
Plug connection	LED mini plug connection M1
Connection to	LED ballast

Sign round

Light Tone	Order No.	PU
Warm white	9 070 705	1 each
Cool white	9 070 703	1 each

Accessories

Article	Order No.	PU
Surface mounting box	9 084 224	1 each
LED ballast 1,5 W – 15 W	9 098 453	1 each
LED extension lead M1, 1800 mm	0 041 762	1 each
6-way LED distributor M1, 2000 mm	9 084 272	1 each

Sets

Set comprising: 3 Sign round lights
1 LED ballast 10 W with 2000 mm supply lead (power pack version)

Light tone	Order No.	PU
Warm white	1 160 131	1 each
Cool white	1 160 132	1 each

- ▶ LED lights
- ▶ Sign round

Dimensional Drawing

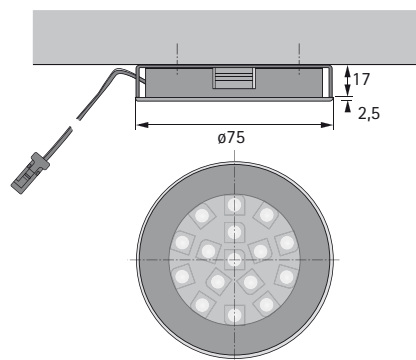
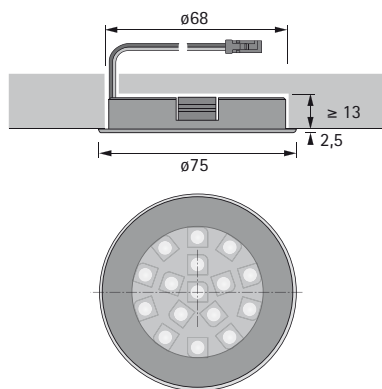

Assembly

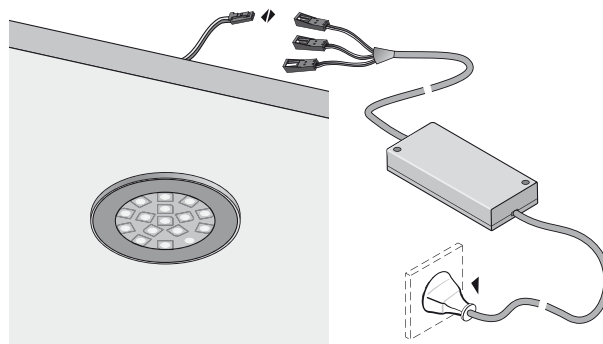
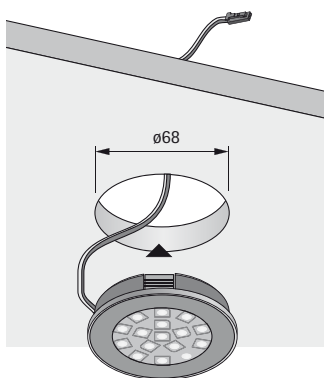

Task Lighting

- LED lights
- BriteSquare L



Light type	Surface-mounting LED light
Illumination type	Task lighting
Surface finish	Polished chrome look
Special feature	Powerful surface-mounting LED light that is easy to install
Ordering information	LED ballast must be ordered separately, see below or refer to page 78



Light Distribution diagram / 64°

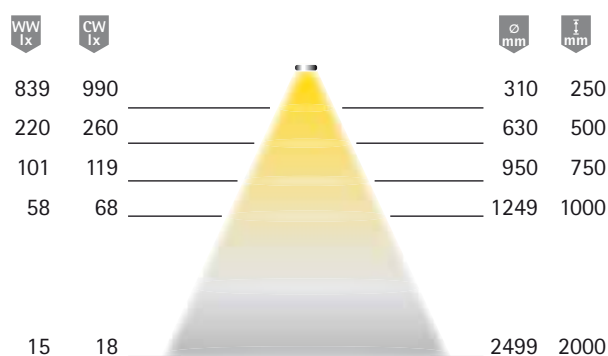

Technical details in brief

Operating voltage	12 Volt DC
Light tone	Warm white / Cool white
Colour reproduction	
RA	> 80 / > 70
Power consumption	2,5 W
Dimmable	Yes
Number of LEDs	9
Light emission angle	64°
Test marks and symbols	CE V V F
IP rating	IP 44
Supply lead	300 mm incl. 1700 mm extension lead
Plug connection	LED mini plug connection M1
Connection to	LED ballast

BriteSquare L

Light Tone	Order No.	PU
Warm white	9 128 486	1 each
Cool white	9 128 487	1 each

Accessories

Article	Order No.	PU
LED ballast 1,5 W – 15 W	9 098 453	1 each
LED extension lead M1, 1800 mm	0 041 762	1 each
6-way LED distributor M1, 2000 mm	9 084 272	1 each

Dimensional Drawing

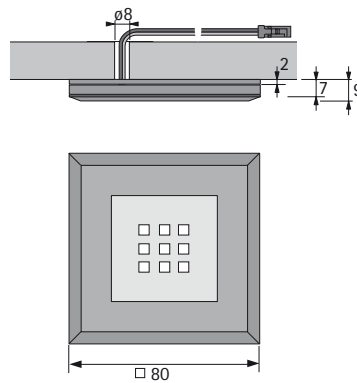

Assembly

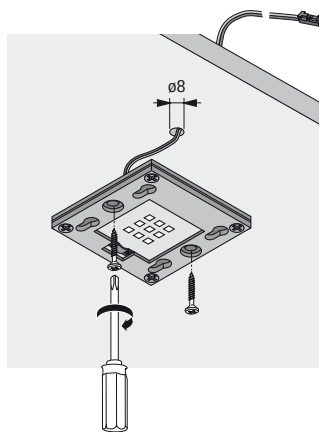

2x

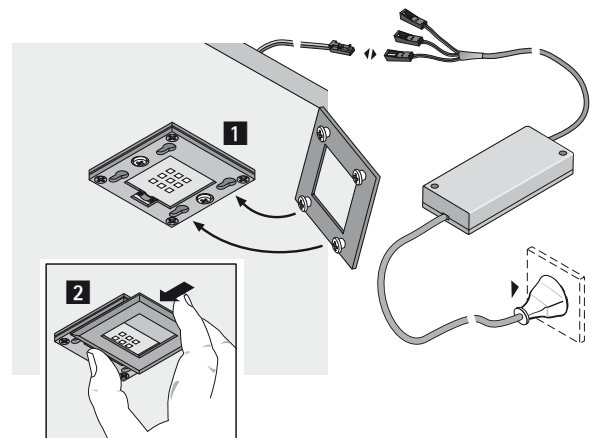
 ø3,5



Task Lighting

- LED lights
- EcoPower



Light type
Illumination type
Surface finish
Special feature
Ordering information





Recessed LED light
Task lighting
Aluminum look finish
Simple recessed LED light for an installed diameter of 56 mm
LED ballast must be ordered separately, see below or refer to page 78
Also available as a set of 3 lights with LED ballast, see below

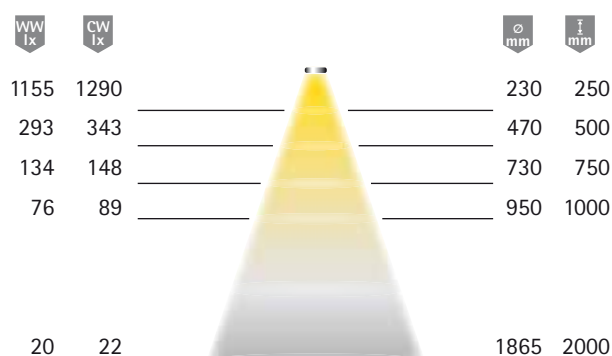

Light Distribution diagram / 50°



Technical details in brief

Operating voltage 12 Volt DC
Light tone Warm white / Cool white
Colour reproduction RA > 80 / > 70
Power consumption 1,7 W
Dimmable Yes
Number of LEDs 24
Light emission angle 50°
Test marks and symbols    
IP rating IP 20
Installed diameter 56mm
Supply lead 300 mm incl. 1700 mm extension lead
Plug connection LED mini plug connection M1
Connection to LED ballast

EcoPower

Light Tone	Order No.	PU
Warm white	9 128 490	1 each
Cool white	9 128 491	1 each

Accessories

Article	Order No.	PU
LED ballast 1,5 W – 15 W	9 098 453	1 each
LED extension lead M1, 1800 mm	0 041 762	1 each
6-way LED distributor M1, 2000 mm	9 084 272	1 each

Sets

Set comprising: 3 EcoPower lights
1 LED ballast 15 W with 2000 mm supply lead

Light tone	Order No.	PU
Warm white	9 138 634	1 each
Cool white	9 138 633	1 each

Dimensional Drawing

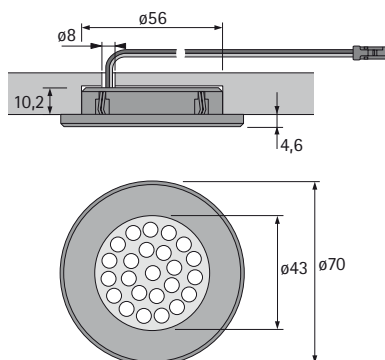

Assembly

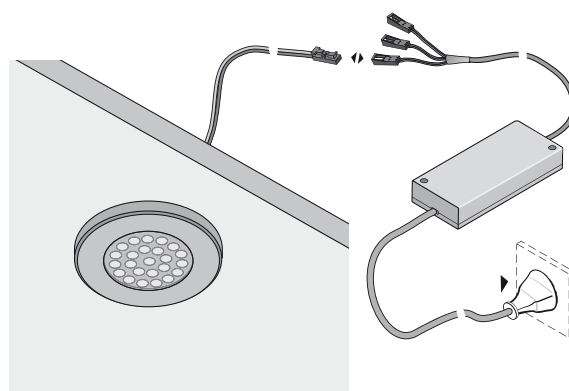
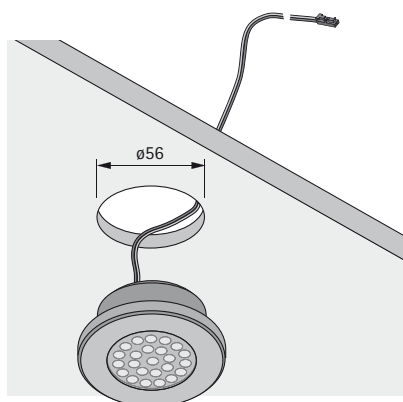

Task Lighting

- ▶ LED lights
- ▶ LuckyInside



Light type
Illumination type
Surface finish
Special feature

Recessed LED light
Task lighting
Aluminium look
Light operated by motion detector and powered by rechargeable or normal batteries
Uses 5 AAA-type batteries (included)



Light Distribution diagram / Front 13°, back 22°

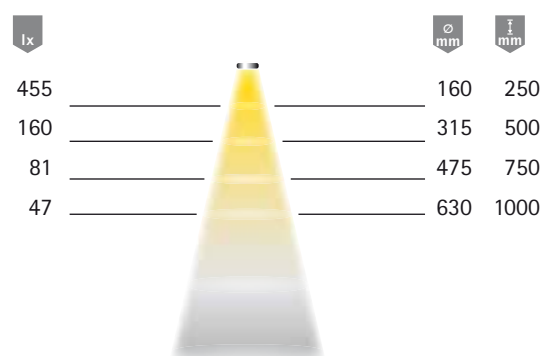

Technical details in brief

Operating voltage	AAA/LR03 (5 x 1,2/1,5 V)
Light tone	Cool white
Colour reproduction	
RA	> 70
Power consumption	0,7 W
Dimmable	No
Number of LEDs	6
Light emission angle	Front 13°, back 22°
Test marks and symbols	CE V V
IP rating	IP 20
Motion detector:	
Detection angle	110°
Reach	2m
Stay-'ON' time:	10 seconds

LuckyInside

Light Tone	Order No.	PU
Cool white	9 127 512	1 each

Task Lighting

- ▶ LED lights
- ▶ LuckyInside

Dimensional Drawing

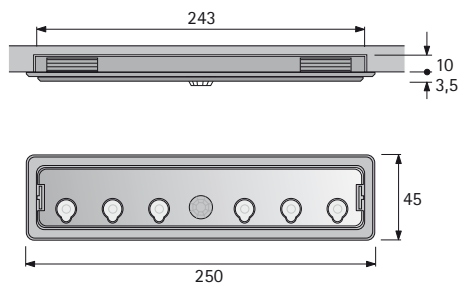

Assembly

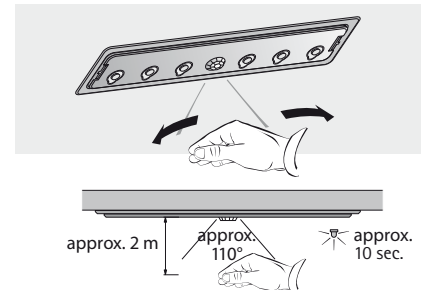
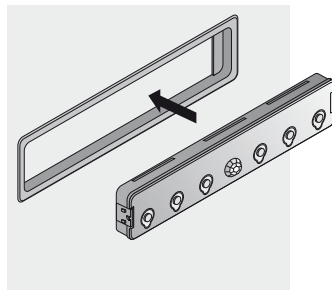
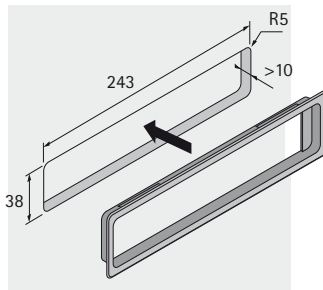

Task Lighting

- ▶ LED lights
- ▶ InnoLine



Light type	Recessed LED light
Illumination type	Task lighting
Surface finish	Aluminium look / plastic transparent
Special feature	Recessed light for illuminating drawers With integrated, automatic sensor switch Can be shortened as required
Ordering information	LED ballast must be ordered separately, see below or refer to page 78



Light Distribution diagram / 32°

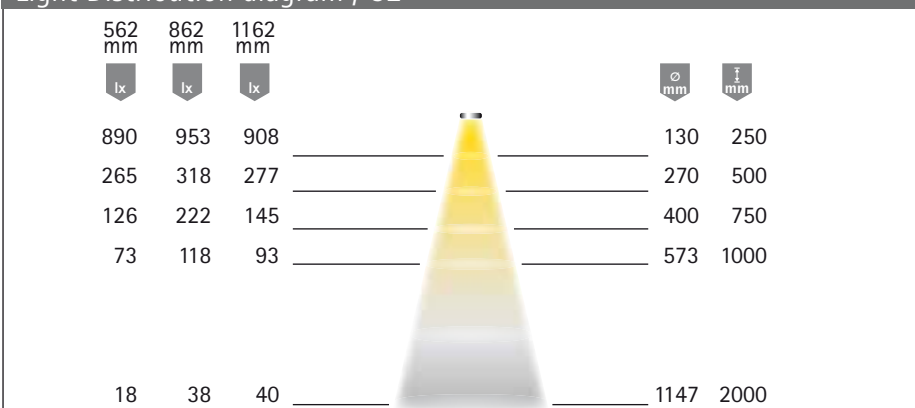

Technical details in brief

Operating voltage	12 Volt DC
Light tone	Cool white
Colour reproduction	
RA	> 70
Power consumption	2,2 W / 5,5 W / 5,5 W
Dimmable	No
Number of LEDs	14 / 28
Light emission angle	32°
Test marks and symbols	CE V V F D
IP rating	IP 20
Supply lead	1500 mm
Plug connection	LED mini plug connection M1
Connection to	LED ballast

InnoLine

Length	Can be shortened to	Order No.	PU
562 mm	462 mm	9 071 730	1 each
862 mm	762 mm	9 070 584	1 each
1162 mm	962 mm	9 070 587	1 each

Accessories

Article	Order No.	PU
LED ballast 1,5 W – 15 W	9 098 453	1 each
LED extension lead M1, 1800 mm	0 041 762	1 each
6-way LED distributor M1, 2000 mm	9 084 272	1 each

Dimensional Drawing

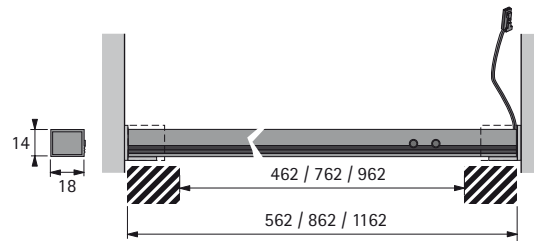

Assembly

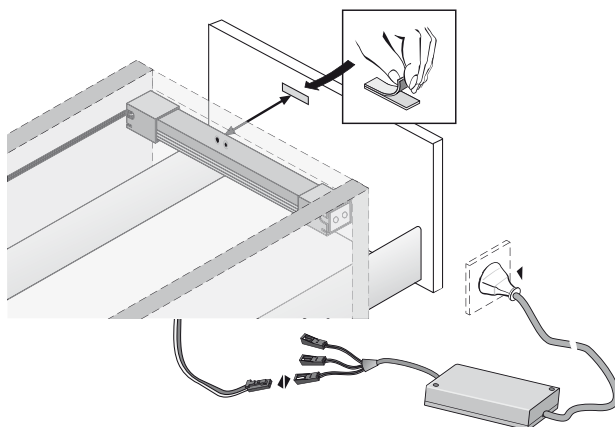
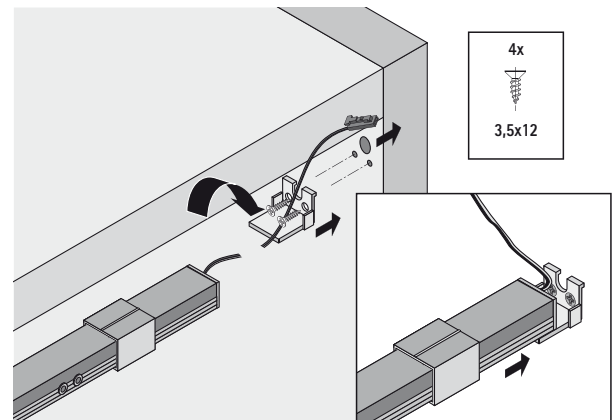
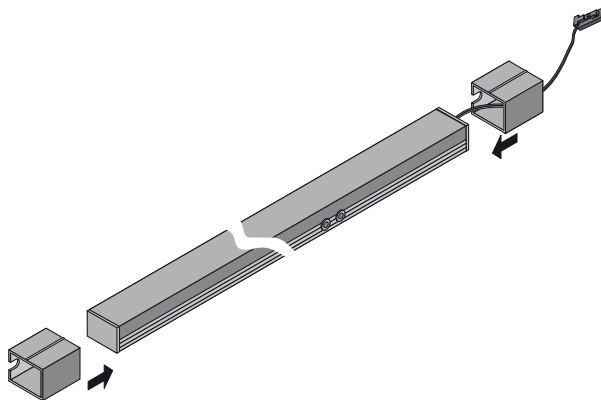

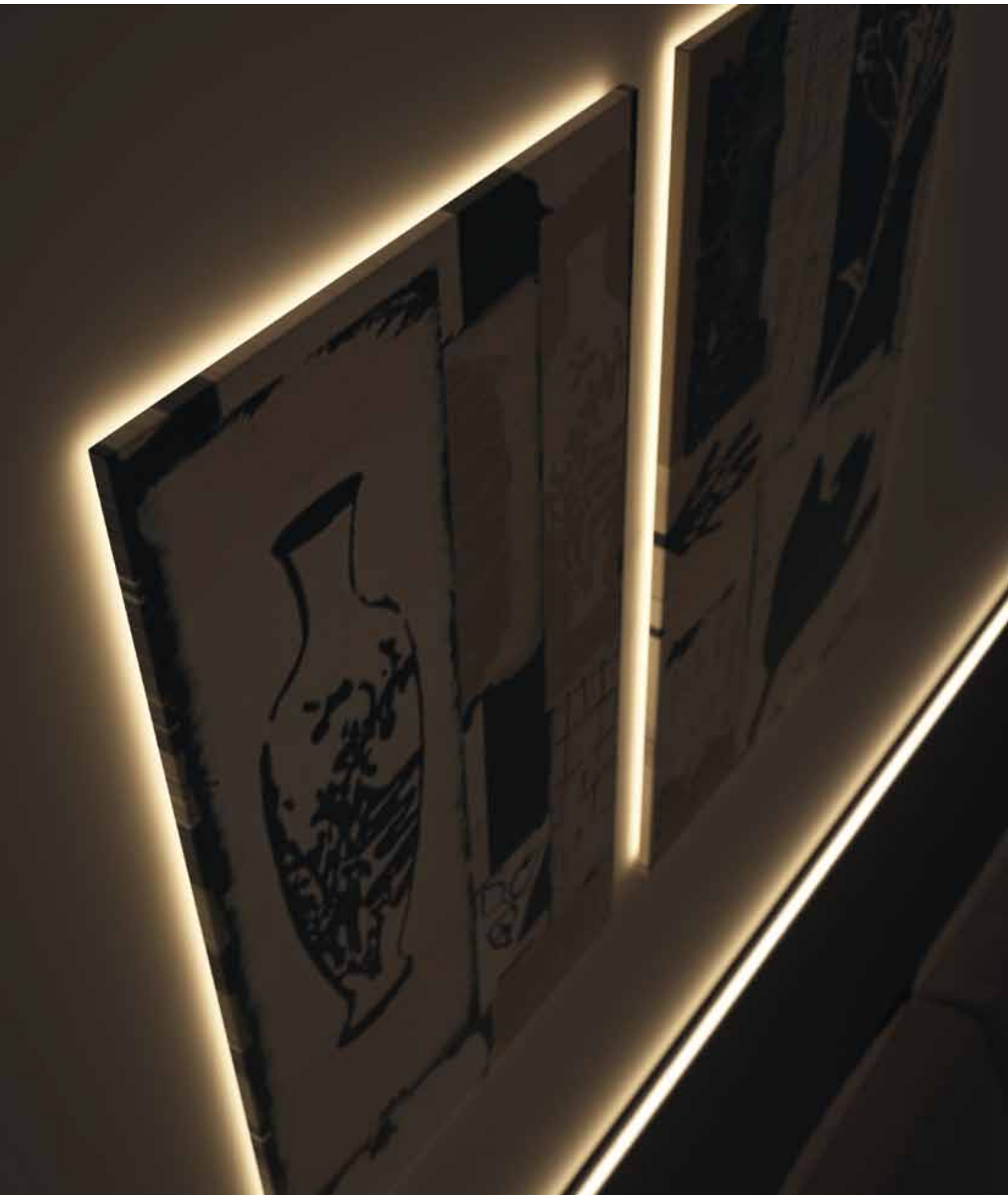

Mood Lighting



Versa
Pages 44 – 45
LED



Versa Inside I
Pages 46 – 47
LED



Versa Inside II
Pages 48 – 49
LED



Versa Inside MultiColor
Pages 50 – 51
LED

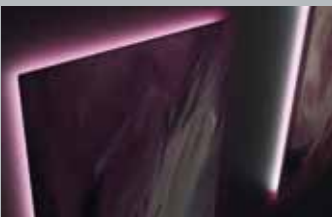

Versa SideView
Pages 52 – 53
LED



Channelline
Pages 54 – 57
Profiles



GlasLine
Pages 58 – 59
LED



StarPoint
Pages 60 – 61
LED



Spot in Plus
Pages 62 – 63
LED



StarPoint mini
Pages 64 – 65
LED



FixPoint
Pages 66 – 67
LED

Mood Lighting

- ▶ LED lights
- ▶ Versa



Light type
Illumination type
Surface finish
Special feature

Surface-mounting LED light
Mood lighting
White
Flexible, self-adhesive LED lighting band for particular effects and customised use in and on furniture
Can be shortened every 60 mm
Supply leads at both ends permits direct use of both cut sections

Ordering information
LED ballast must be ordered separately, see below or refer to page 78

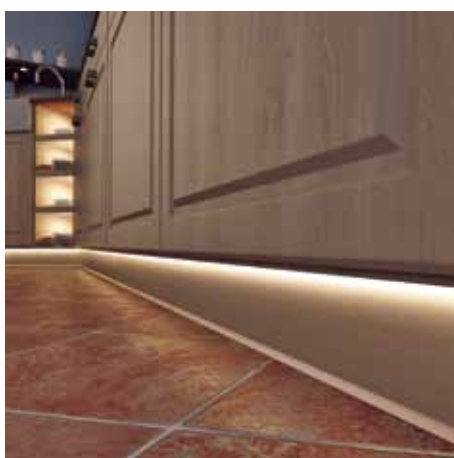

Light Distribution diagram / 64°

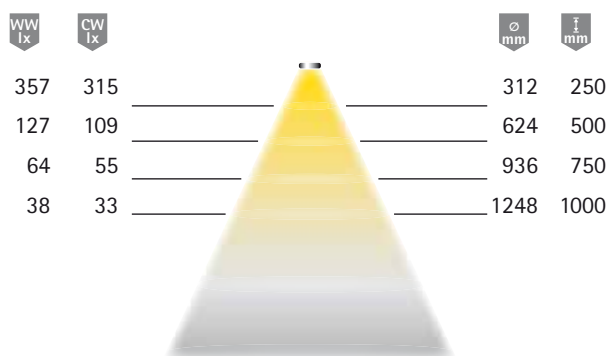

Technical details in brief

Operating voltage
Light tone
Colour reproduction
RA
Power consumption
Dimmable
Number of LEDs
Light emission angle
Test marks
and symbols
IP rating
Supply lead
Plug connection
Connection to

12 Volt DC
Warm white / Cool white
> 70
6,5 W / 14 W
Yes
3 each 60 mm
64°
CE V V F D E
IP 20
2 x 1000 mm
LED mini plug connection M1
LED ballast

Versa

Length	Output	Order No. Warm white	Order No. Cool white	PU
1200 mm	6,5 W	9 069 976	9 069 968	1 each
4800 mm	14 W	9 069 973	9 069 964	1 each

Accessories

Article	Order No.	PU
Versa inside corner	9 069 840	10 each
Versa outside corner	9 071 802	10 each
LED ballast 1,5 W – 15 W	9 098 453	1 each
LED ballast 30 W	9 138 076	1 each
LED extension lead M1, 1800 mm	0 041 762	1 each
6-way LED distributor M1, 2000 mm	9 084 272	1 each

Dimensional Drawing

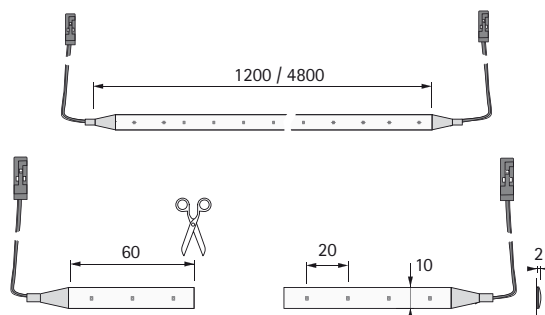

Installation with inside corner

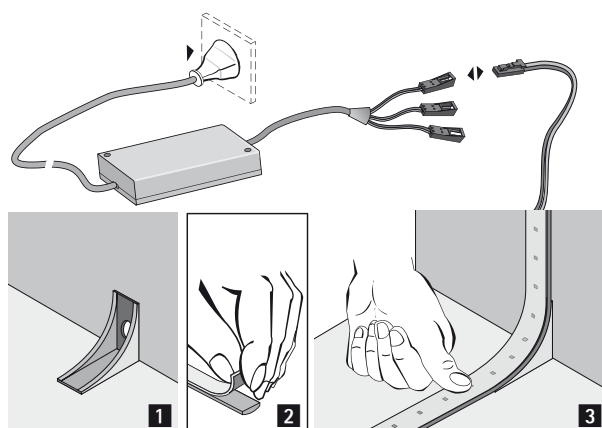

Installation with outside corner

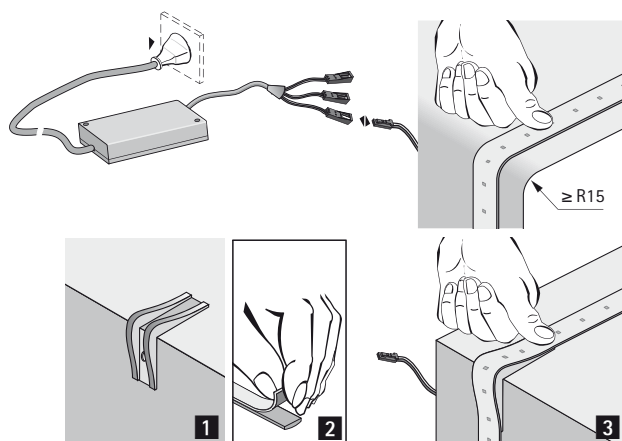

Mood Lighting

- ▶ LED lights
- ▶ Versa Inside I



Light type
Illumination type
Special feature

Surface-mounting LED light

Task / Mood lighting

Flexible, self-adhesive LED lighting band with powerful LEDs
Can only be used in conjunction with ChannelLine profiles or heat absorbing surfaces/materials
Can be shortened every 100 mm

Ordering information

Supply leads at both ends permits direct use of both cut sections
LED ballast must be ordered separately, see below or refer to page 80

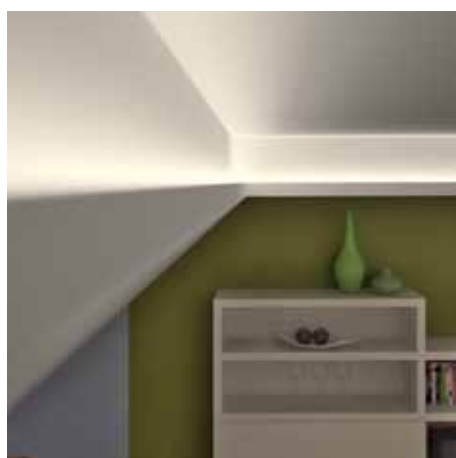

Light Distribution diagram / 68°

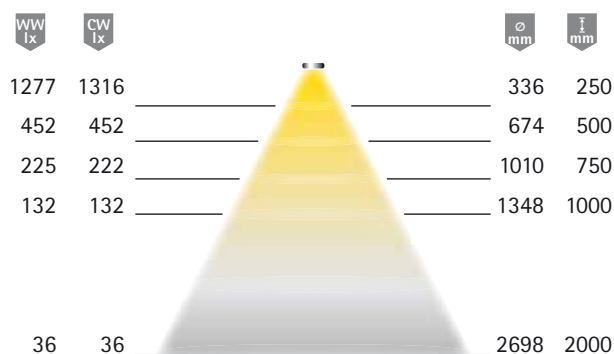

Technical details in brief

Operating voltage	24 Volt DC
Light tone	Warm white / Cool white
Colour reproduction	
RA	> 60 / > 70
Power consumption	18 W / 72 W
Dimmable	Yes
Number of LEDs	6 each 100 mm
Light emission angle	68°
Test marks and symbols	CE
IP rating	IP 20
Supply lead	2 x 1700 mm
Plug connection	LED multi plug MP2
Connection to	LED ballast

Versa Inside I

Length	Output	Order No. Warm white	Order No. Cool white	PU
1200 mm	18 W	9 128 512	9 128 510	1 each
5000 mm	72 W	9 128 511	9 128 509	1 each

Accessories

Article	Order No.	PU
Versa feeder for 1700 mm sections	9 128 513	1 each
Flexible Versa connector, 100 mm	9 128 514	10 each
Versa connector for sections	9 128 515	10 each
LED ballast, 75 W with mains-voltage plug connector	9 138 075	1 each
LED extension lead MP2, 1800 mm	9 128 294	1 each
2-way LED distributor MP2	9 129 453	1 each
6-way LED distributor MP2	9 129 455	1 each

Dimensional Drawing

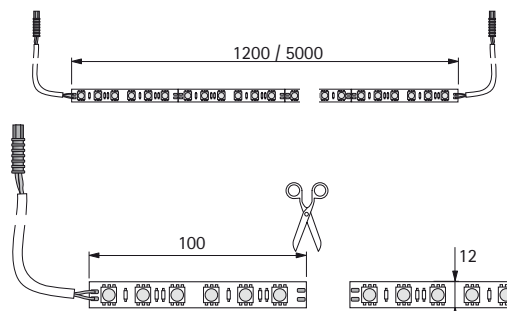

Assembly

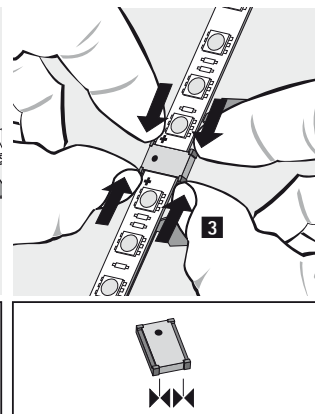
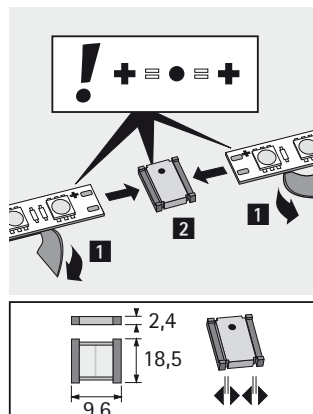
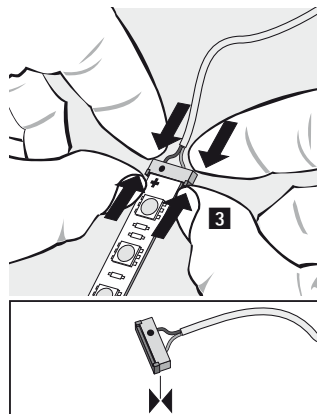
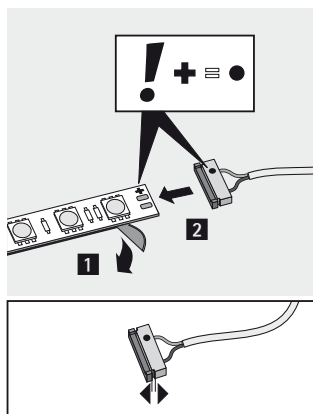
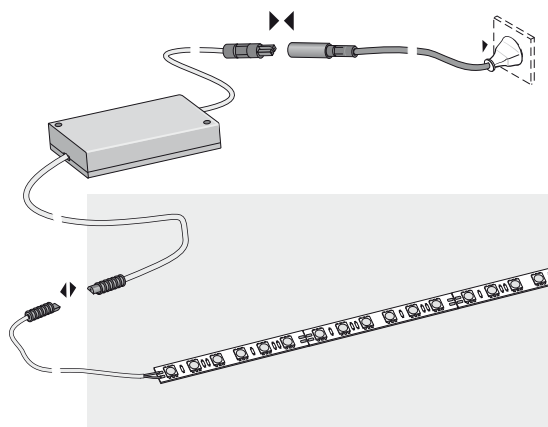
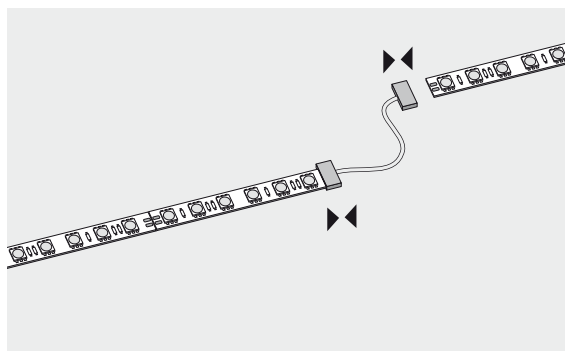

Mood Lighting

- ▶ LED lights
- ▶ Versa Inside II



Light type
Illumination type
Special feature

Surface-mounting LED light
Mood / orientation lighting
Flexible, self-adhesive LED lighting band with powerful LEDs
Can only be used in conjunction with ChannelLine profiles or heat absorbing surfaces/materials
Can be shortened every 50 mm
Supply leads at both ends permits direct use of both cut sections
LED ballast must be ordered separately, see below or refer to page 80

Ordering information



Light Distribution diagram / 68°

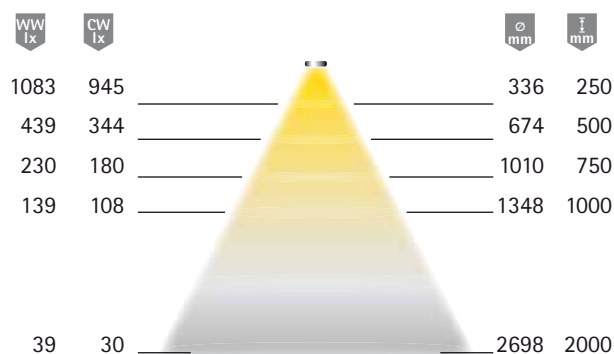

Technical details in brief

Operating voltage	24 Volt DC
Light tone	Warm white / Cool white
Colour reproduction	
RA	> 70 / > 80
Power consumption	12 W / 48 W
Dimmable	Yes
Number of LEDs	6 each 50 mm
Light emission angle	68°
Test marks and symbols	CE
IP rating	IP 20
Supply lead	2 x 1700 mm
Plug connection	LED multi plug MP2
Connection to	LED ballast

Versa Inside II

Length	Output	Order No. Warm white	Order No. Cool white	PU
1200 mm	12 W	9 128 523	9 128 521	1 each
5000 mm	48 W	9 128 522	9 128 520	1 each

Accessories

Article	Order No.	PU
Versa feeder for 1700 mm sections	9 128 524	1 each
Flexible Versa connector, 100 mm	9 128 525	10 each
Versa connector for sections	9 128 526	10 each
LED ballast, 75 W with mains-voltage plug connector	9 138 075	1 each
LED extension lead MP2, 1800 mm	9 128 294	1 each
2-way LED distributor MP2	9 129 453	1 each
6-way LED distributor MP2	9 129 455	1 each

Dimensional Drawing

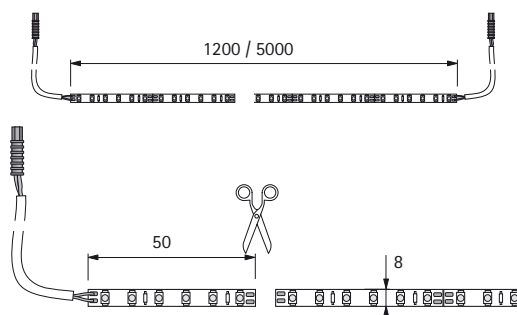

Assembly

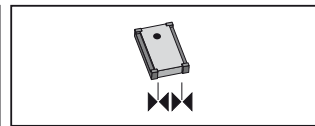
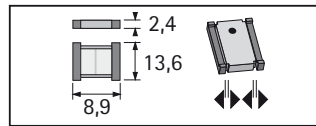
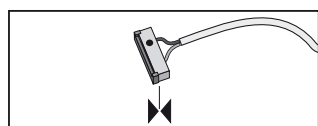
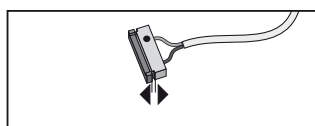
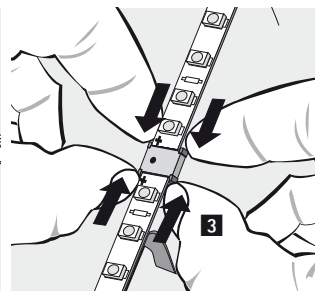
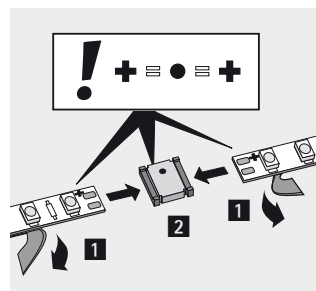
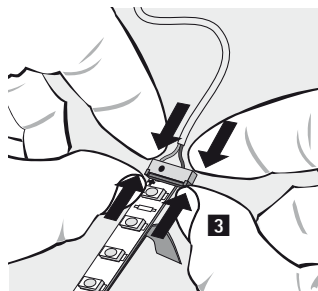
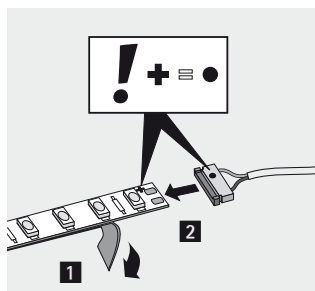
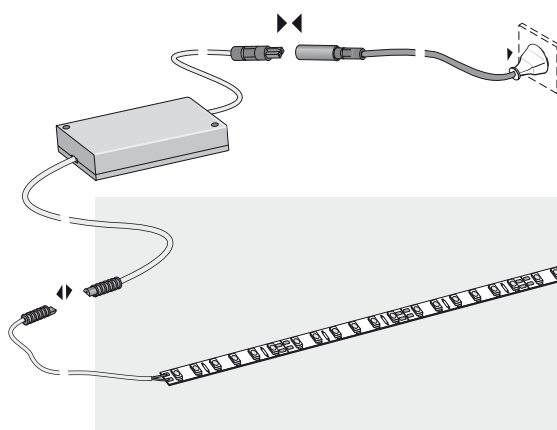
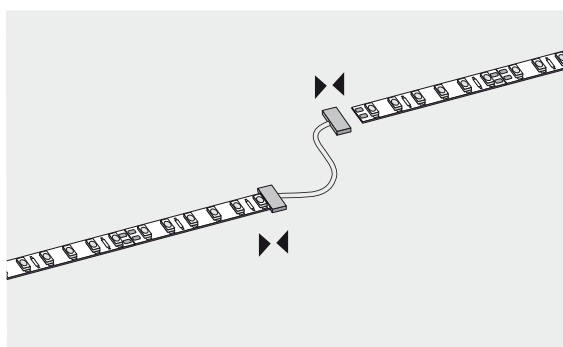

Mood Lighting

- ▶ LED lights
- ▶ Versa Inside MultiColor



Light type
Illumination type
Special feature

Surface-mounting LED light
Mood lighting
Flexible, self-adhesive colour-change system with powerful RGB LEDs
Can only be used in conjunction with ChannelLine profiles or heat absorbing surfaces/materials
Can be shortened every 100 mm

Ordering information

Supply leads at both ends permits direct use of both cut sections
LED ballast, LED ColorMatic Avanti must be ordered separately, see below or refer to page 80 for LED ballast details



Versa Inside MultiColor

Length	Output	Order No.	PU
1200 mm	18 W	9 128 517	1 each
5000 mm	72 W	9 128 516	1 each

Accessories

Article	Order No.	PU
ColorMatic Avanti 72 W	9 129 088	1 each
Versa feeder for 1700 mm sections	9 128 518	1 each
Flexible Versa connector, 100 mm	9 128 519	10 each
LED ballast, 75 W with mains-voltage plug connector	9 138 075	1 each
LED extension lead LED MultiColor 1800 mm	0 040 163	1 each
LED MultiColor 3-way distributor 180 mm	0 040 164	1 each

Technical details in brief

Operating voltage	24 Volt DC
Light tone	Colour-change system
Power consumption	18 W / 72 W
Dimmable	No
Number of LEDs	6 each 100 mm
Light emission angle	68°
Test marks and symbols	CE
IP rating	IP 20
Supply lead	2 x 1700 mm
Plug connection	LED RGB plug connector
Connection to	RGB colour-change controller and LED ballast

- ▶ LED lights
- ▶ Versa Inside MultiColor

Dimensional Drawing

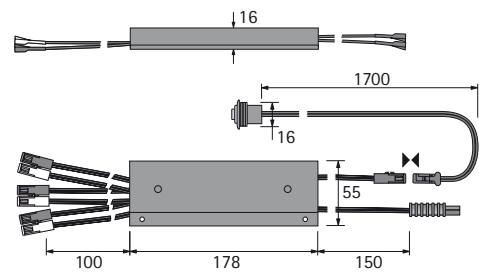
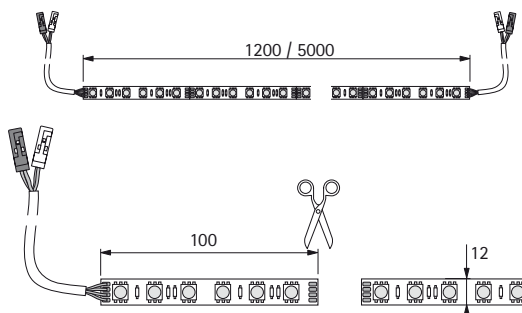

Assembly

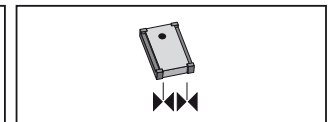
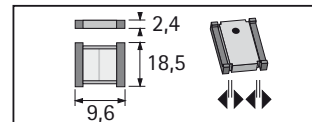
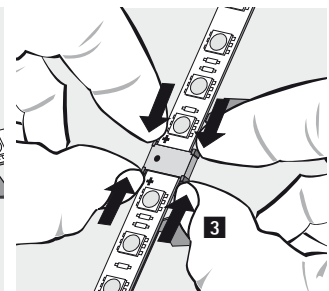
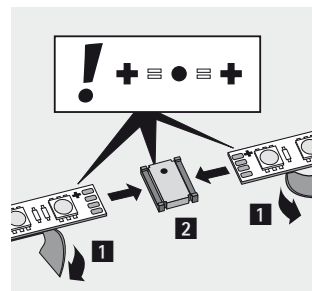
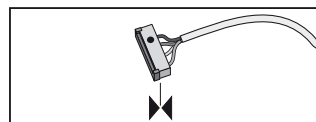
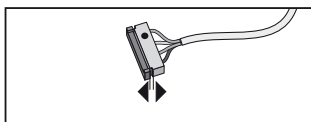
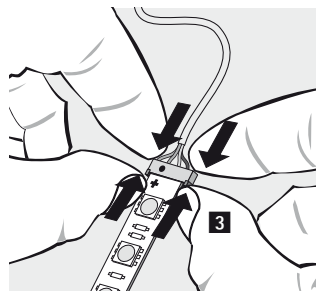
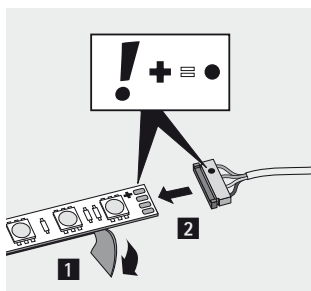
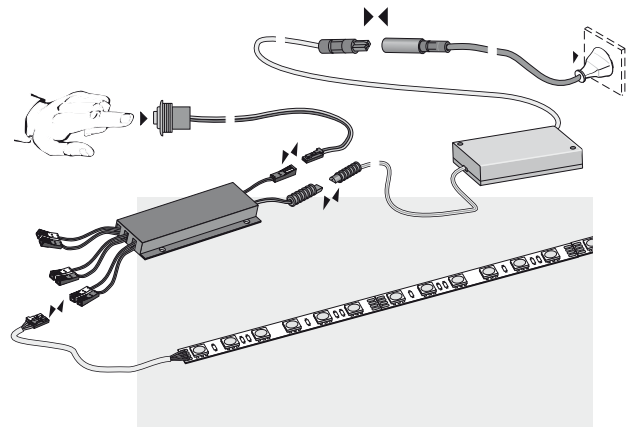
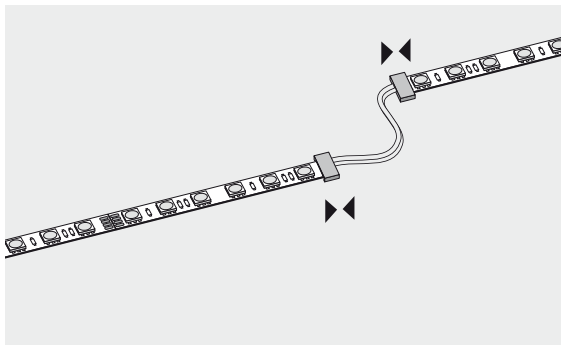

Mood Lighting

- ▶ LED lights
- ▶ Versa SideView



Light type
Illumination type
Special feature

Surface-mounting LED light
Mood / orientation lighting
Flexible, self-adhesive LED lighting band with LEDs emitting light to the side
Can be shortened every 50 mm
Supply leads at both ends permits direct use of both cut sections
LED ballast must be ordered separately, see below or refer to page 78

Ordering information

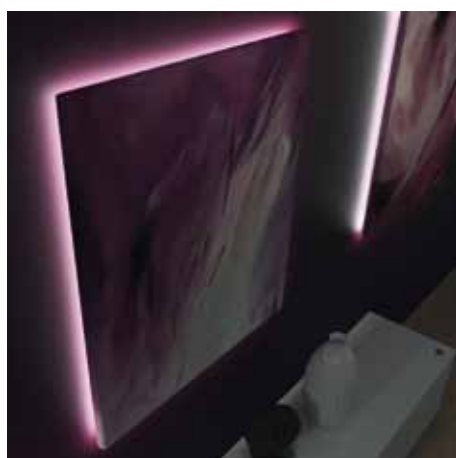

Light Distribution diagram / 68°

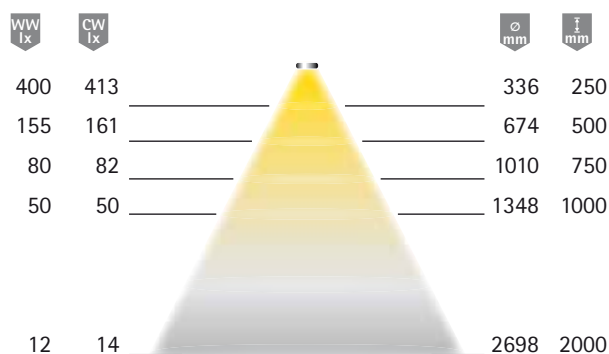

Technical details in brief

Operating voltage	12 Volt DC
Light tone	Warm white / Cool white
Colour reproduction	
RA	> 80 / > 60
Power consumption	24 W
Dimmable	Yes
Number of LEDs	3 each 50 mm
Light emission angle	68°
Test marks and symbols	CE
IP rating	IP 20
Supply lead	2 x 1700 mm
Plug connection	LED mini plug connector M1
Connection to	LED ballast

Versa SideView

Light Tone	Order No.	PU
Warm white	9 128 528	1 each
Cool white	9 128 527	1 each

Accessories

Article	Order No.	PU
Versa feeder for 1700 mm sections	9 128 529	1 each
Flexible Versa connector, 100 mm	9 128 530	10 each
LED ballast 30 W	9 138 076	1 each
LED extension lead M1, 1800 mm	0 041 762	1 each

Dimensional Drawing

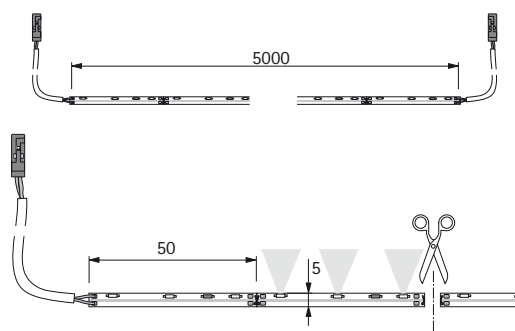

Assembly

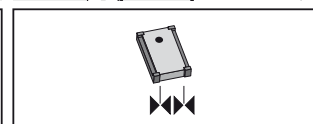
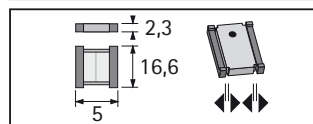
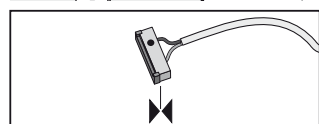
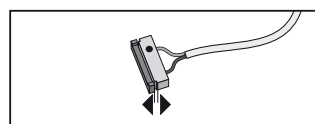
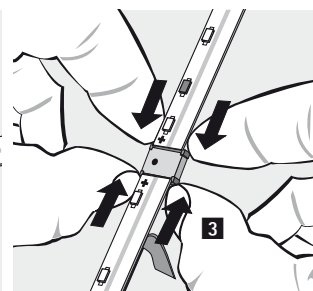
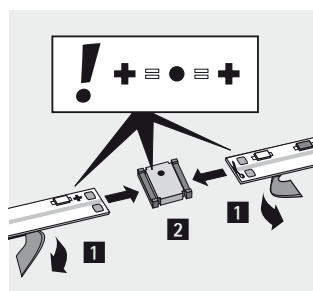
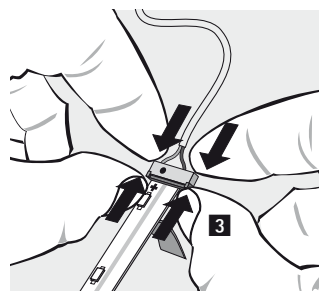
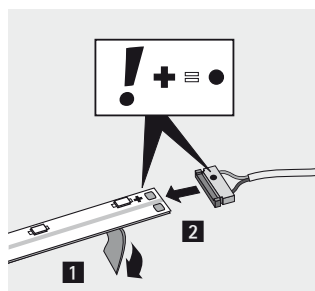
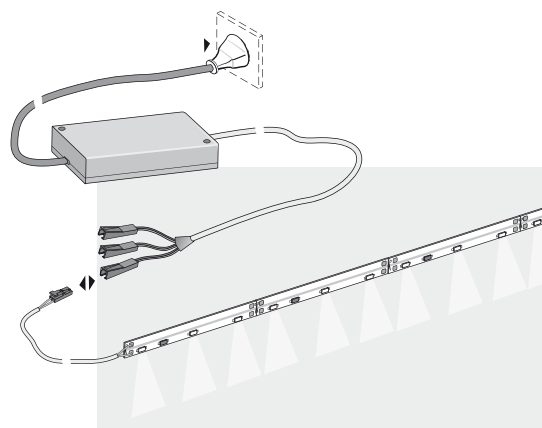
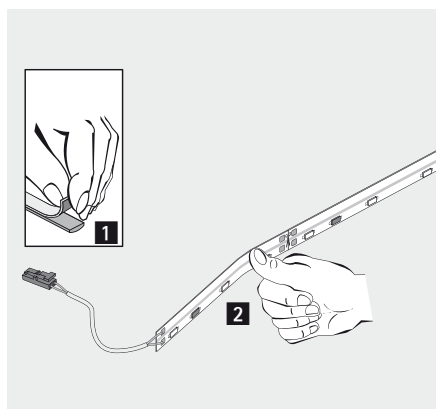

Mood Lighting

- ▶ LED lights
- ▶ ChannelLine

Special feature	Aluminium profile with translucent plastic cover for combining with the LED lighting bands from the Versa range
Ordering information	Versa LED lighting band, LED ballast and other accessories need to be ordered separately, see pages 44-51

ChannelLine 1



Article	Length	Order No.	PU
Profile	4000 mm	9 084 267	1 each
End cap, right & left		9 106 400	1 set

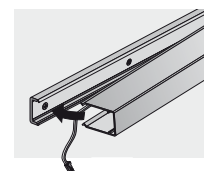
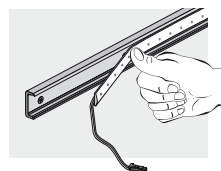
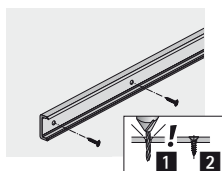
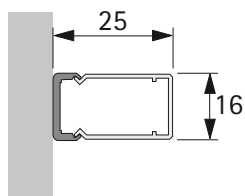

ChannelLine 2



Article	Length	Order No.	PU
Profile	2000 mm	9 116 710	1 each
End cap		9 117 386	1 each

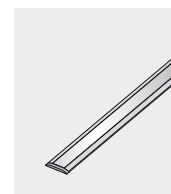
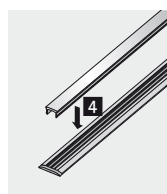
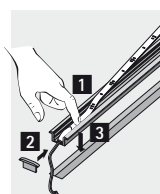
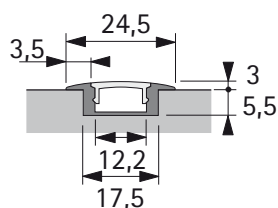

Mood Lighting

- LED lights
- Channelline

Special feature	Aluminium profile with translucent plastic cover for combining with the LED lighting bands from the Versa range
Ordering information	Versa LED lighting band, LED ballast and other accessories need to be ordered separately, see pages 44-51

Channelline 3



Article	Length	Order No.	PU
Profile	2000 mm	9 117 387	1 each
End cap		9 117 067	1 each

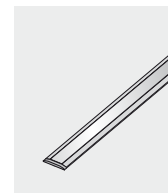
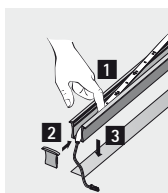
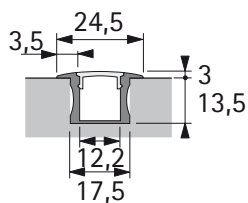

Channelline 4



Article	Length	Order No.	PU
Profile	2000 mm	9 117 062	1 each
End cap		9 117 068	1 each

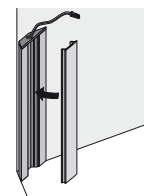
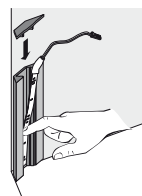
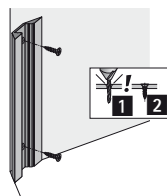
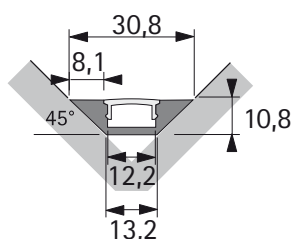

Mood Lighting

- ▶ LED lights
- ▶ ChannelLine

Special feature

Aluminium profile with translucent plastic cover for combining with the LED lighting bands from the Versa range

Ordering information

Versa LED lighting band, LED ballast and other accessories need to be ordered separately, see pages 44-51

ChannelLine 5



Article	Length	Order No.	PU
Profile	2000 mm	9 117 063	1 each
End cap		9 117 069	1 each

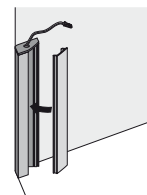
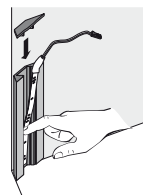
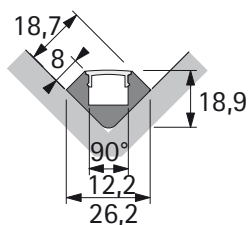

ChannelLine 6



Article	Length	Order No.	PU
Profile	2000 mm	9 117 064	1 each
End cap		9 117 070	1 each

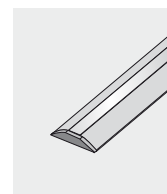
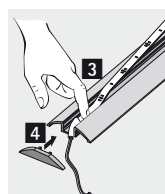
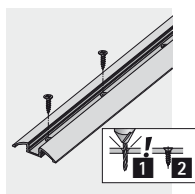
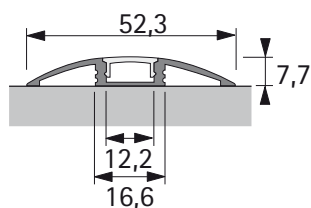

Mood Lighting

- LED lights
- Channelline

Special feature

Aluminium profile with translucent plastic cover for combining with the LED lighting bands from the Versa range

Ordering information

Versa LED lighting band, LED ballast and other accessories need to be ordered separately, see pages 44-51

Channelline 7

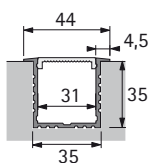

Article	Length	Order No.	PU
Profile	2000 mm	9 117 065	1 each
End cap		9 117 071	1 each

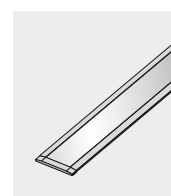
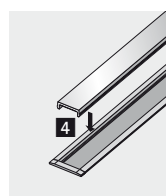
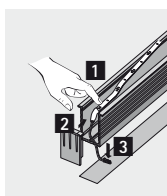

Channelline 8

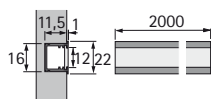

Article	Length	Order No.	PU
Profile	2000 mm	9 129 456	1 each
End cap, right & left		9 129 459	1 set

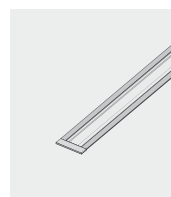
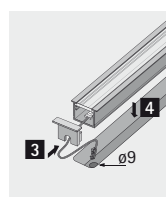
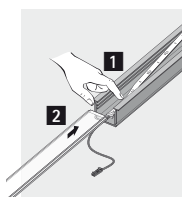

Channelline 10

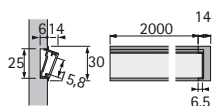

Article	Length	Order No.	PU
Profile	2000 mm	9 129 499	1 each
End cap, right & left		9 129 502	1 set

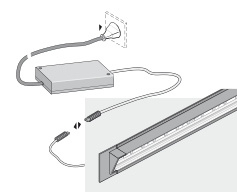
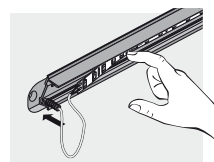
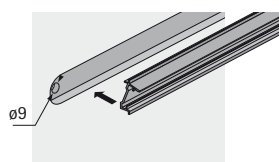

Mood Lighting

- ▶ LED lights
- ▶ LED GlasLine



Light type	Surface-mounting LED light
Illumination type	Mood lighting
Special feature	Surface-mounting LED light for illuminating the edge of an 8 mm thick glass shelf to stunning effect It is recommended to use a white glass shelf (Optiwhite) with matt-finished edge (Sandblasted)
Ordering information	LED ballast must be ordered separately, see below or refer to page 78
Note	Pay attention to the minimum load of the ballast







LED GlasLine

Length	Can be shortened to	Light tone	Order No.	PU
566 mm	438 mm	Warm white	9 128 057	1 each
566 mm	438 mm	Cool white	9 128 054	1 each
866 mm	668 mm	Warm white	9 129 060	1 each
866 mm	668 mm	Cool white	9 128 058	1 each

Accessories

Article	Order No.	PU
LED ballast 1,5 W – 15 W	9 098 453	1 each
LED extension lead M1, 1800 mm	0 041 762	1 each
6-way LED distributor M1, 2000 mm	9 084 272	1 each

Technical details in brief

Operating voltage	12 Volt DC
Light tone	Warm white / Cool white
Colour reproduction	
RA	> 70
Power consumption	0,8 W / 1,2 W
Dimmable	Yes
Number of LEDs	6 / 9
Light emission angle	68°
Test marks and symbols	CE    
IP rating	IP 20
Supply lead	1700 mm
Plug connection	LED mini plug connection M1
Connection to	LED ballast

- ▶ LED lights
- ▶ LED GlasLine

Dimensional Drawing

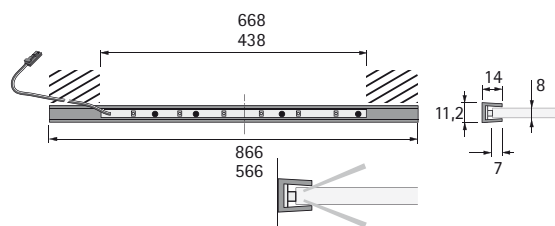

Assembly

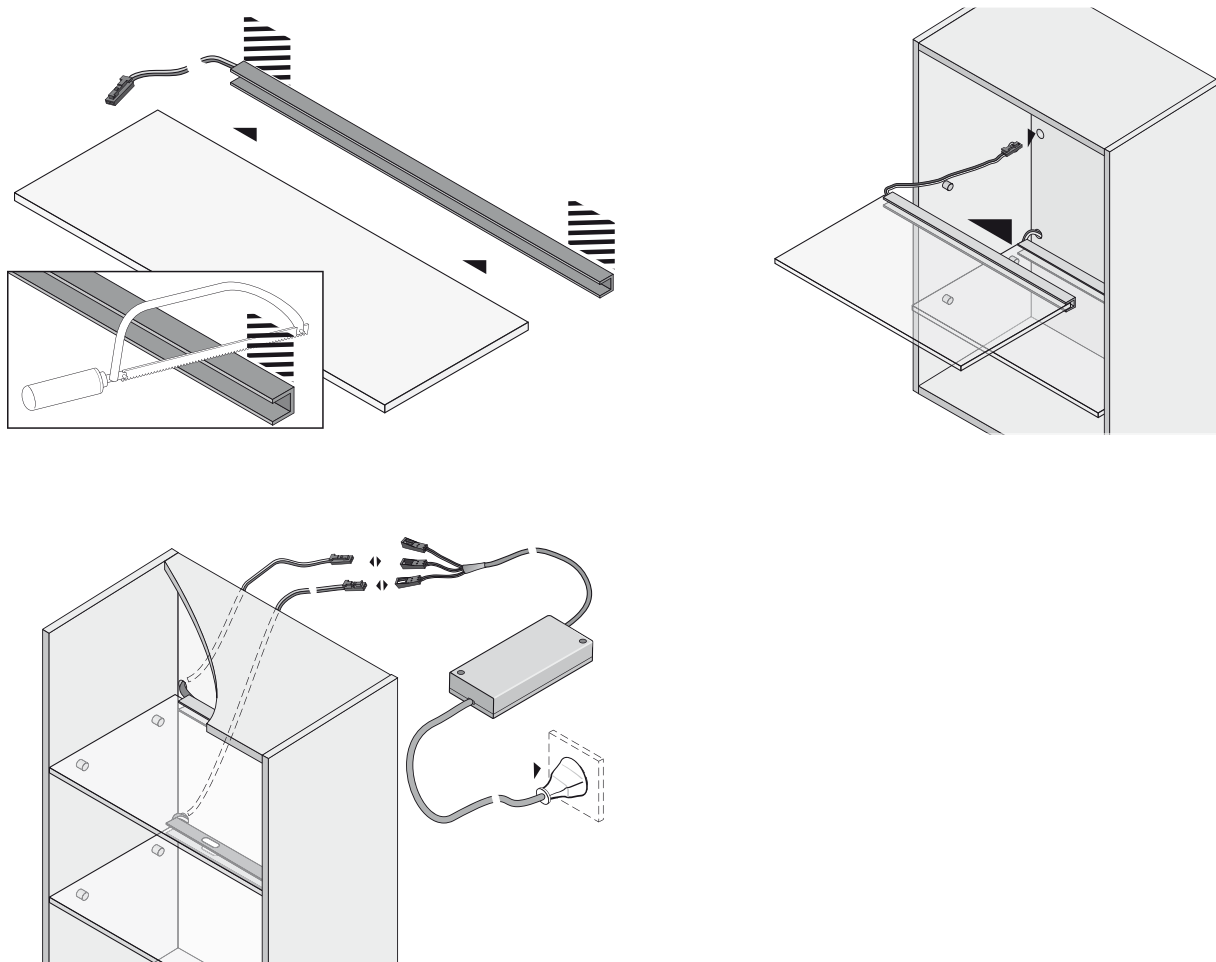

Mood Lighting

- ▶ LED lights
- ▶ StarPoint



Light type	Recessed / surface-mounting LED light
Illumination type	Mood lighting
Surface finish	Aluminium look
Special feature	Powerful LED light with integrated spot reflector and height-adjustable light cylinder
Ordering information	LED ballast must be ordered separately, see below or refer to page 78

Note Pay attention to the minimum load of the ballast

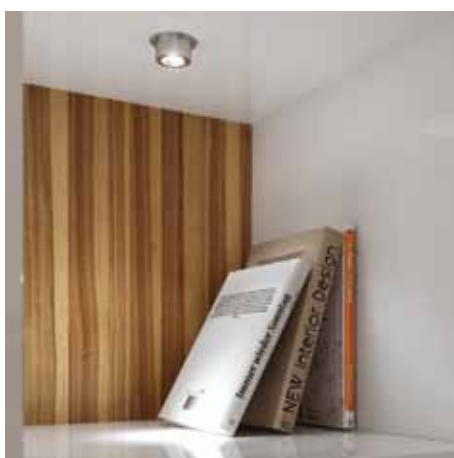

Light Distribution diagram / 10°

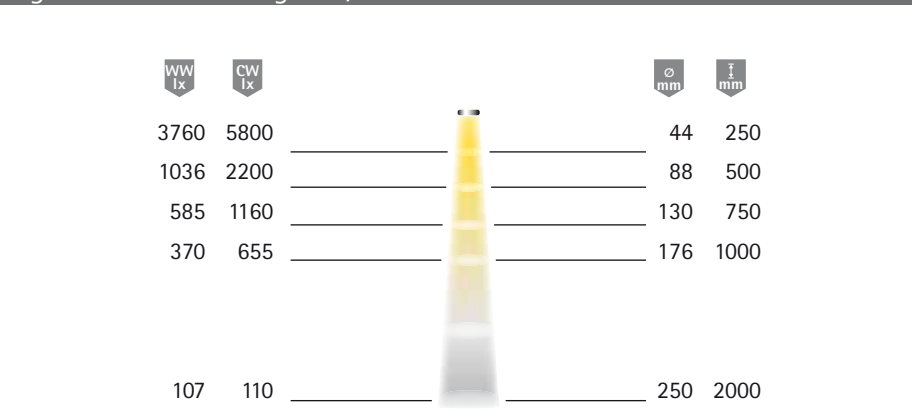

Technical details in brief

Operating voltage	12 Volt DC
Light tone	Warm white / Cool white
Colour reproduction	
RA	>90 / > 80
Power consumption	1,2 W
Dimmable	No
Number of LEDs	1
Light emission angle	10°
Test marks and symbols	CE V V F D
IP rating	IP 20
Installed diameter	40 mm
Supply lead	1700 mm
Plug connection	LED mini plug connection M1
Connection to	LED ballast

StarPoint

Light tone	Order No.	PU
Warm white	9 070 847	1 each
Cool white	9 070 822	1 each

Accessories

Article	Order No.	PU
LED ballast 1,5 – 15 W	9 098 453	1 each
LED extension lead M1, 1800 mm	0 041 762	1 each
6-way LED distributor M1, 2000 mm	9 084 272	1 each

Dimensional Drawing

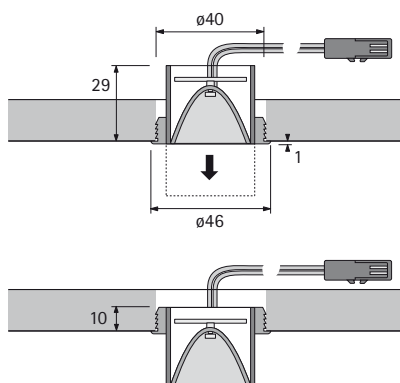

Assembly

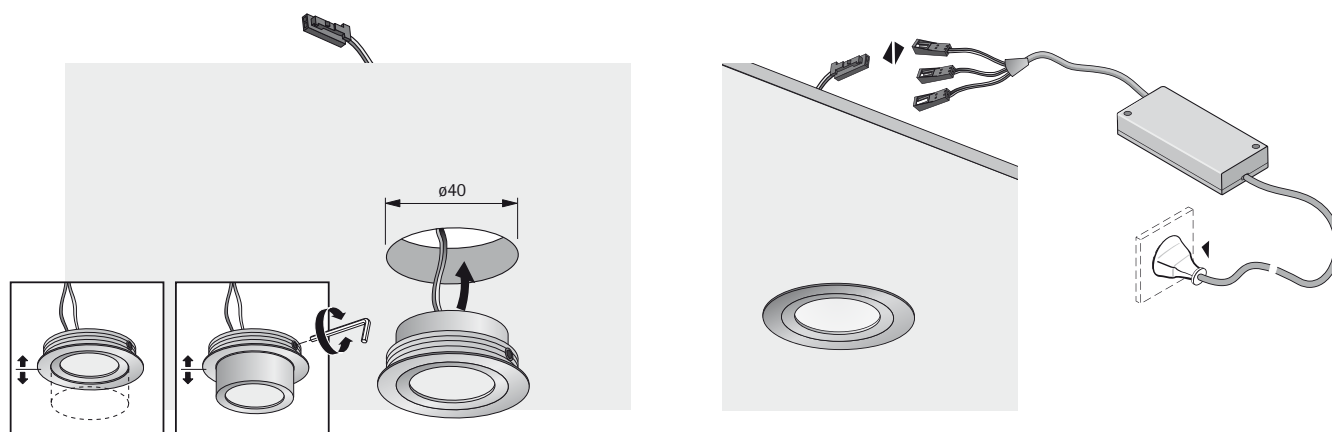

Mood Lighting

- LED lights
- Spot in Plus



Light type	Recessed / surface-mounting LED light
Illumination type	Mood lighting
Surface finish	Stainless-steel look
Special feature	Compact LED light with integrated lens Highly concentrated light cone
Ordering information	LED ballast must be ordered separately, see below or refer to page 82 Also available as a set of 3 lights with LED ballast , see below

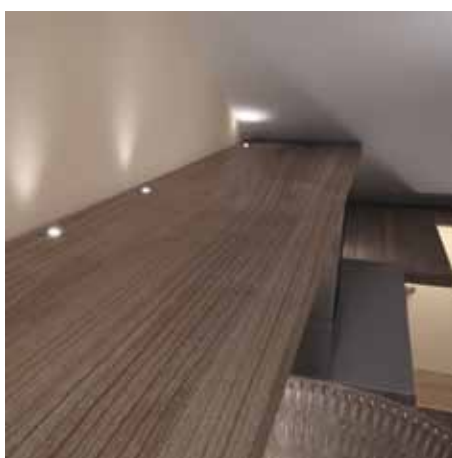

Light Distribution diagram / 16°

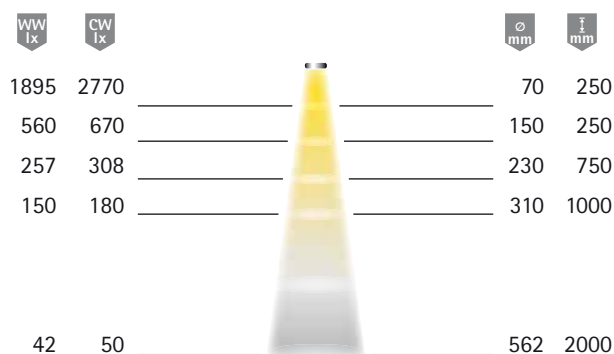

Technical details in brief

Operating current	350 mA
Light tone	Warm white / Cool white
Colour reproduction	
RA	> 80 / > 70
Power consumption	1 W
Dimmable	Yes
Number of LEDs	1
Light emission angle	16°
Test marks and symbols	◆
IP rating	IP 20
Installed diameter	40 mm
Supply lead	300 mm incl. 1700 mm extension lead
Plug connection	LED mini plug connection M2
Connection to	LED ballast

Spot in Plus

Light Tone	Order No.	PU
Warm white	9 128 501	1 each
Cool white	9 128 502	1 each

Accessories

Article	Order No.	PU
Add-on housing for Spot in / Spot in Plus	9 128 496	1 each
LED ballast 12 W, 350 mA	9 138 077	1 each
LED extension lead M2, 1800 mm	9 130 680	1 each

Sets

Set comprising: 3 Spot in Plus lights
1 LED ballast 12 W, 350 mA with 2000 mm supply lead

Light tone	Order No.	PU
Warm white	9 138 636	1 set
Cool white	9 138 635	1 set

Dimensional Drawing

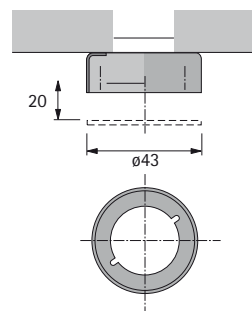
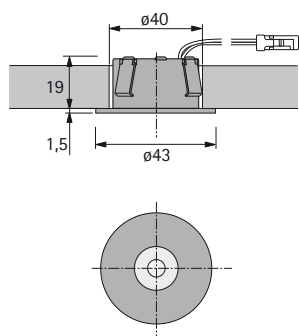

Assembly

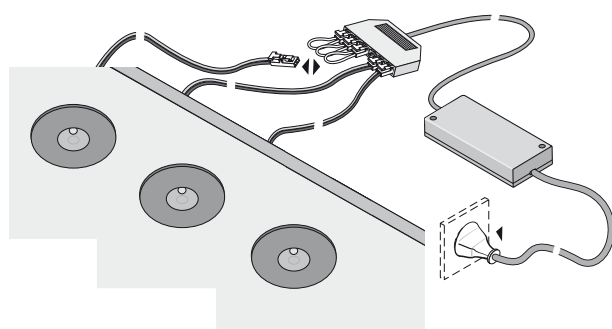
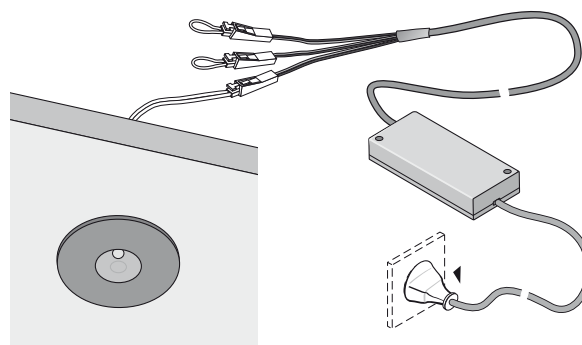
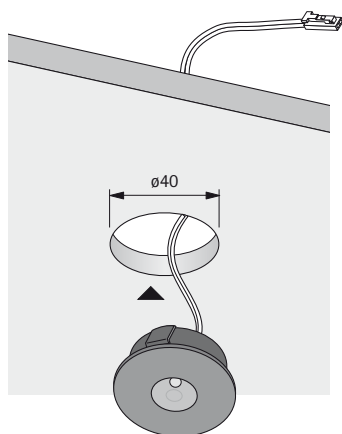

Mood Lighting

- ▶ LED lights
- ▶ StarPoint mini



Light type	Recessed / surface-mounting LED light
Illumination type	Mood lighting
Surface finish	Aluminium look
Special feature	Compact LED light with integrated spot reflector
Ordering information	LED ballast must be ordered separately, see below or refer to page 78

Note Pay attention to the minimum load of the ballast

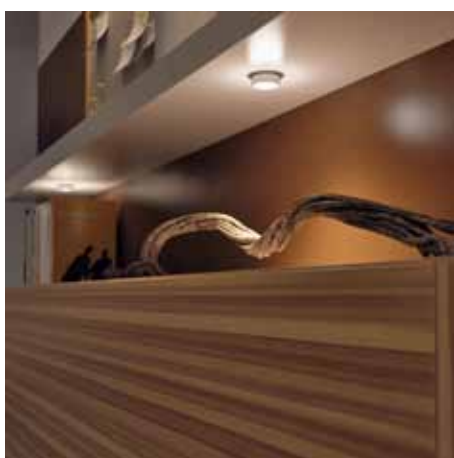

Light Distribution diagram / 24°

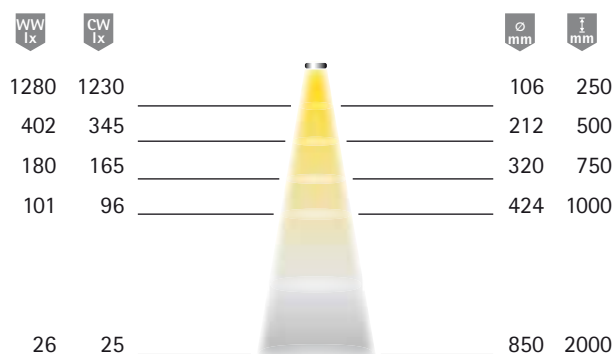

Technical details in brief

Operating voltage	12 Volt DC
Light tone	Warm white / Cool white
Colour reproduction	
RA	>80 / > 70
Power consumption	1,2 W
Dimmable	No
Number of LEDs	1
Light emission angle	24°
Test marks and symbols	CE V V F D
IP rating	IP 20
Installed diameter	40 mm
Supply lead	1700 mm
Plug connection	LED mini plug connection M1
Connection to	LED ballast

StarPoint mini

Light tone	Order No.	PU
Warm white	9 070 845	1 each
Cool white	9 070 843	1 each

Accessories

Article	Order No.	PU
Surface-mounting box for StarPoint mini	9 070 820	1 each
LED ballast 1,5 – 15 W	9 098 453	1 each
LED extension lead M1, 1800 mm	0 041 762	1 each
6-way LED distributor M1, 2000 mm	9 084 272	1 each

Dimensional Drawing

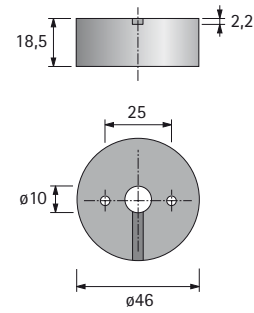
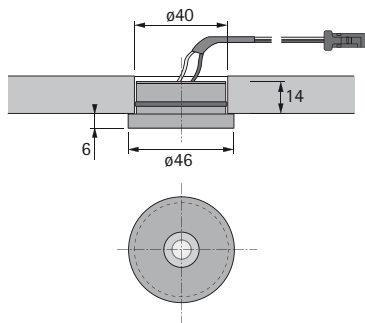

Assembly

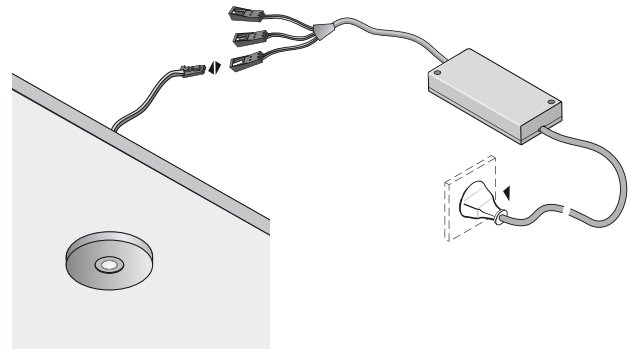
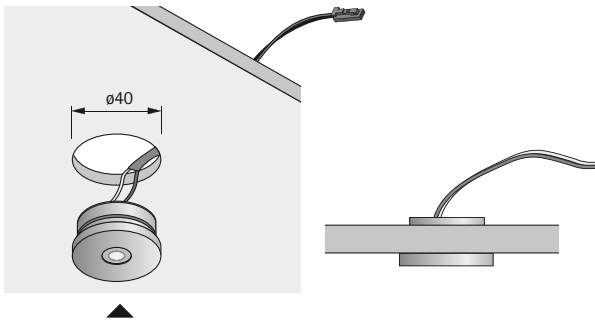

Mood Lighting

- LED lights
- FixPoint



Light type Recessed LED light
 Illumination type Mood lighting
 Surface finish Aluminium look
 Special feature Miniaturised recessed LED light for stunning mood lighting
 Ordering information LED ballast must be ordered separately, see below or refer to page 78





Note Pay attention to the minimum load of the ballast

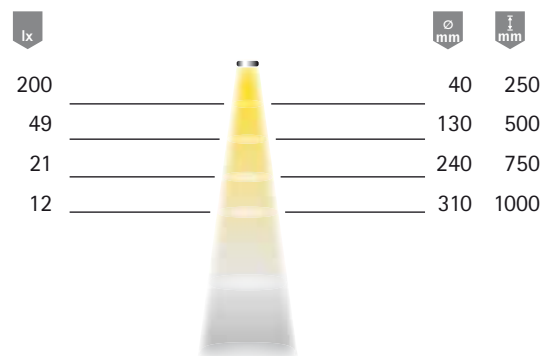

Light Distribution diagram / 16°



Technical details in brief

Operating voltage 12 Volt DC
 Light tone Cool white
 Colour reproduction RA > 70
 Power consumption 0,2 W
 Dimmable Yes
 Number of LEDs 1
 Light emission angle 16°
 Test marks and symbols     
 IP rating IP 20
 Installed diameter 14 mm
 Supply lead 1700 mm
 Plug connection LED mini plug connection M1
 Connection to LED ballast

FixPoint

Order No.	PU
9 070 695	1 each

Accessories

Article	Order No.	PU
LED ballast 1,5 – 15 W	9 098 453	1 each
Mains-voltage feeder with mHV2 plug conn. system 2000 mm	9 128 088	1 each
LED extension lead M1, 1800 mm	0 041 762	1 each
6-way LED distributor M1, 2000 mm	9 084 272	1 each

Dimensional Drawing

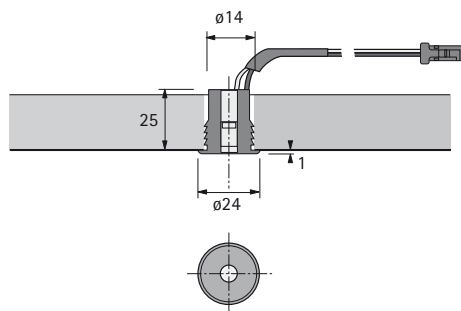

Assembly

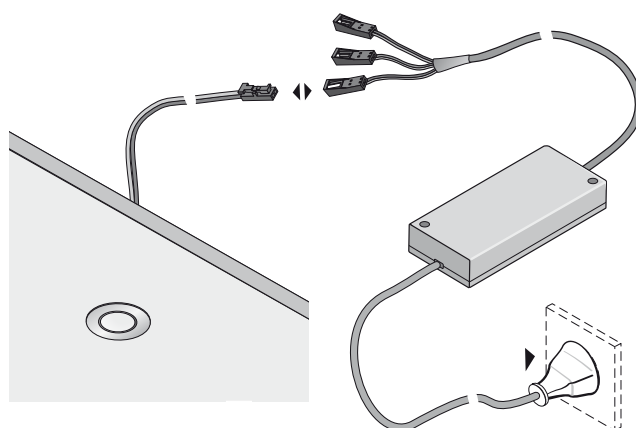
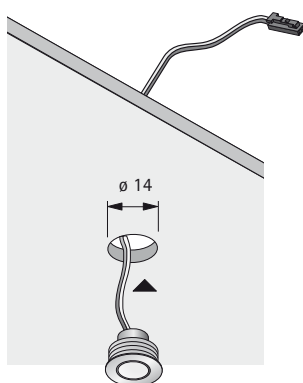



Switch systems



LED Dimmer
Page 70
LED switch systems



LED Dimmer
Page 71
LED switch systems



Tri-Mitter wireless switch
Page 72
LED switch systems



No-touch LED sensor switch
Page 73
LED switch systems



No-touch LED sensor switch
MiniSwitch
Page 74
LED switch systems



LED door-contact switch with
sensor
Page 75
LED switch systems



Mains-voltage switch
Page 76
Switch systems

12V

-

LED dimmer must not be used in conjunction with sensor switch or wireless switch

Order No.	PU
9 070 251	1 each

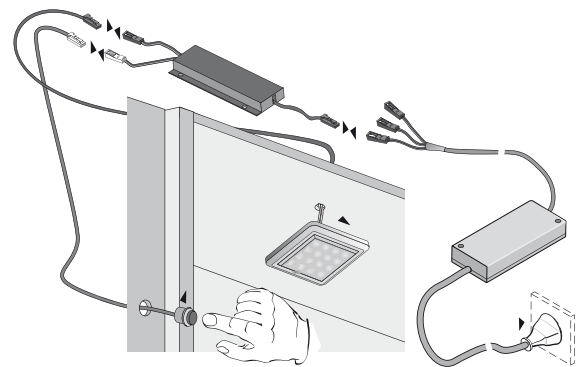
[illegible]

- ▶ LED switch systems
- ▶ LED dimmer



Function

The LED dimmer allows you to switch and dim LED lights or groups of LED lights operating on 24 V DC
Can either be operated by thumbwheel or using the infrared-remote control (supplied).

Supply lead

1700 mm to LED ballast
300 mm to LED light



Suitable for use with

Versa I & II

Note

LED dimmer must not be used in conjunction with sensor switch or wireless switch

Technical details in brief

Plug connection LED multi plug MP2
Switching voltage 24 Volt DC
Max. switching capacity 144 W
Test marks and symbols  

LED dimmer

Order No.	PU
9 127 539	1 each

Dimensional drawing / Assembly

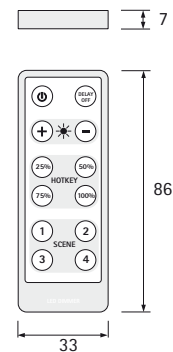
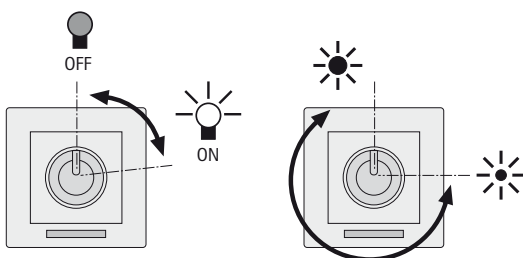
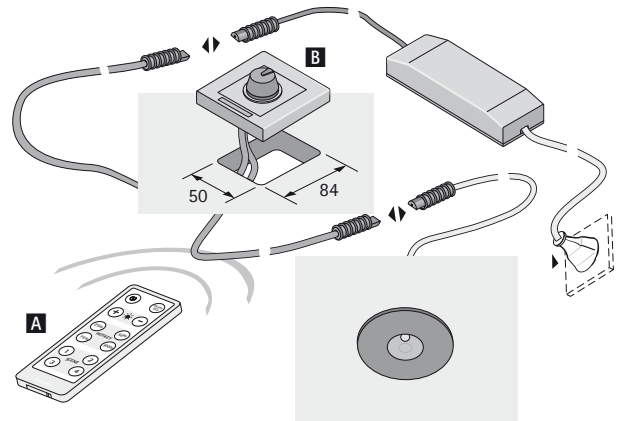
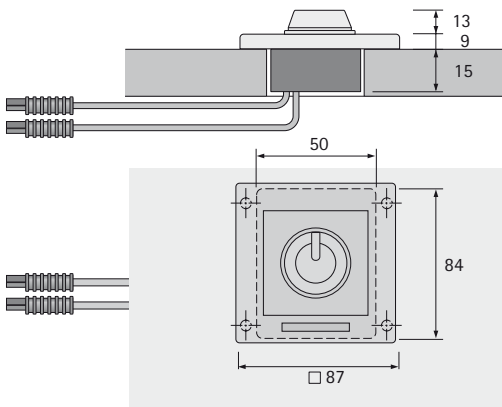

- ▶ LED switch systems
- ▶ Tri-Mitter wireless switch



Description
Function

Supply lead



Suitable for use with
Set comprising

Note

3-channel switch and dimmer for LED lights.
Providing stunning effects, lighting moods can be created in furniture by activating or dimming up to 3 independent channels
150 mm to LED ballast
160 mm to LED light
LED lights
Tri-Mitter receiver, TriMitter remote control in aluminium effect plastic, drill-hole mounting ring

Can only be used with LED ballasts without minimum loading capacity
The Tri-Mitter's transmitter is compatible with the receivers from the X-Mitter system

Technical details in brief

Plug connection LED mini plug
connection M1
Switching voltage 12 Volt DC
Max. switching capacity 3 x 36 W
Test marks and symbols   

Tri-mitter wireless switch

Article	Order No.	PU
TriMitter set	9 127 514	1 set
TriMitter remote control	9 127 515	1 each

Dimensional drawing / Assembly

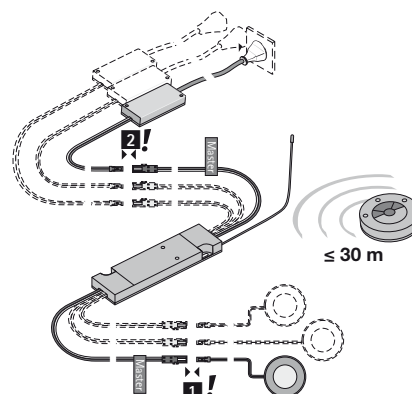
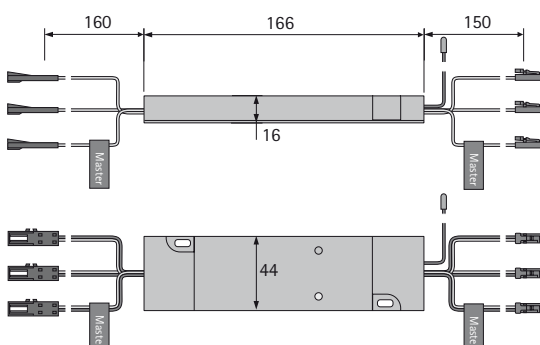
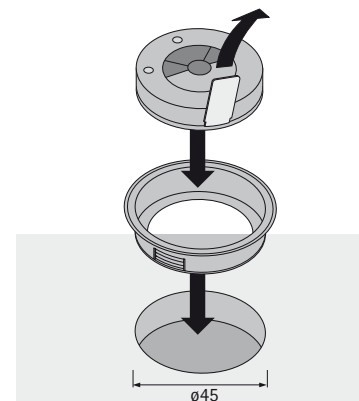
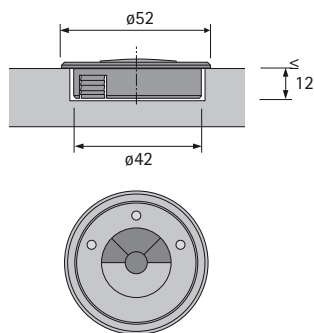

- ▶ LED switch systems
- ▶ No-touch LED sensor switch



Function

The no-touch LED sensor switch is the ideal solution wherever you wish or need to operate lights without touching a switch (e.g. when your hands are dirty in the kitchen). The "light on" and "light off" function is activated simply by moving your hand towards the sensor (at a distance of 5 – 50 mm). All LED lights connected to the sensor switch are switched on and off automatically.

Supply lead

1700 mm to LED ballast

Switch lead

300 mm to LED light





Suitable for use with

1700 mm with sensor housing
LED lights

Note

Additional surface-mounting sensor housing included

Technical details in brief

Plug connection	LED mini plug connection M1
Switching voltage	12 Volt DC
Max. switching capacity	36 W
Test marks and symbols	CE    

No-touch LED sensor switch

Order No.	PU
9 070 597	1 each

Dimensional drawing / Assembly

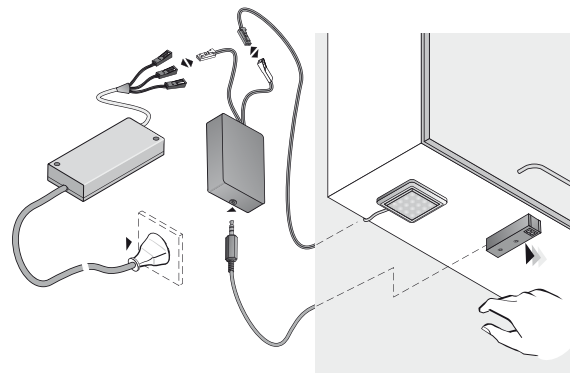
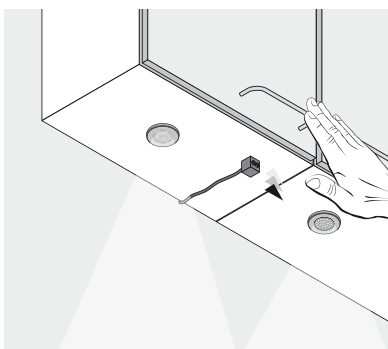
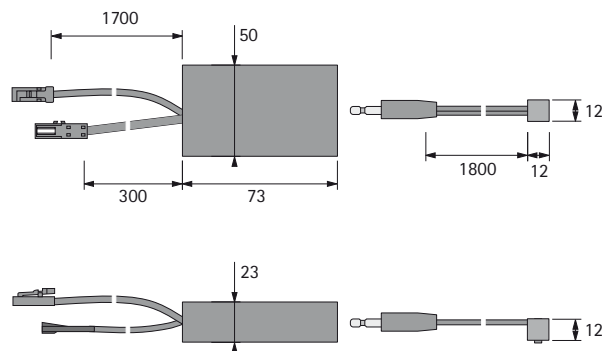

- ▶ LED switch systems
- ▶ MiniSwitch No-touch LED sensor switch



Function

The no-touch sensor switch is the ideal solution wherever you wish or need to operate lights without touching a switch (e.g. when your hands are dirty in the kitchen). The "light on" and "light off" function is activated simply by moving your hand towards the sensor (at a distance of 0 - 30 mm). All lights connected to the sensor switch are switched on and off automatically.





Supply lead

2000 mm to LED ballast

Suitable for use with

2000 mm to LED light
LED lights

Technical details in brief

Plug connection LED mini plug connection M1
Switching voltage 12 Volt DC
Max. switching capacity 30 W
Test marks and symbols    

MiniSwitch No-touch LED sensor switch

Order No.	PU
9 128 507	1 each

Dimensional drawing / Assembly

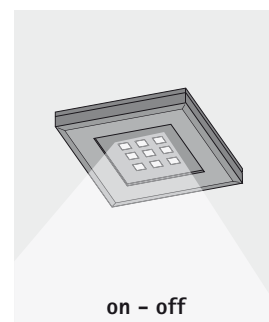
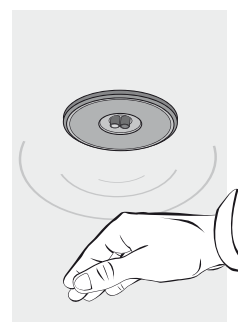
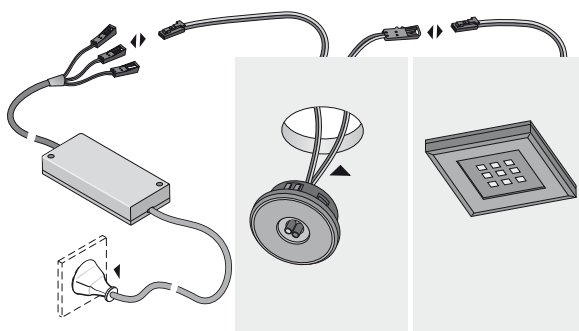
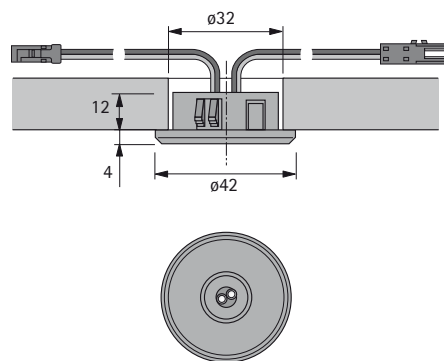

- ▶ LED switch systems
- ▶ LED door-contact switch with sensor



Function

The "light on" or "light off" function is activated by a hinged or sliding door moving across the sensor (at a distance of 5 - 50 mm). All lights connected to the door-contact switch come on or go out automatically.

Supply lead

1700 mm to LED ballast

Switch lead

300 mm to LED light

Suitable for use with

1700 mm with sensor housing
LED lights

Note

Additional surface-mounting sensor housing included

Technical details in brief

Plug connection

LED mini plug
connection M1

Switching voltage

12 Volt DC

Max. switching capacity

36 W

Test marks and symbols

CE

LED door-contact switch with sensor

Order No.

9 070 599

PU

1 each

Dimensional drawing / Assembly

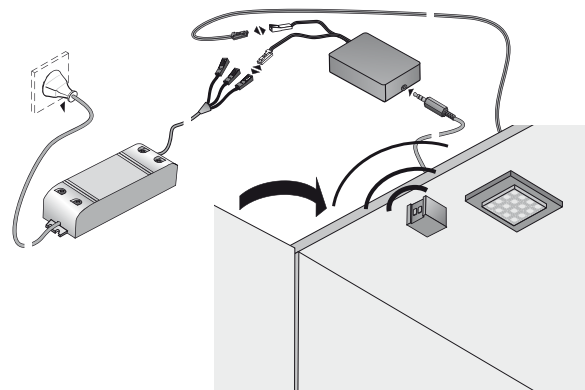
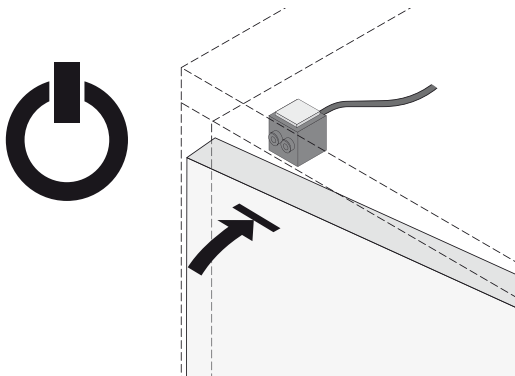
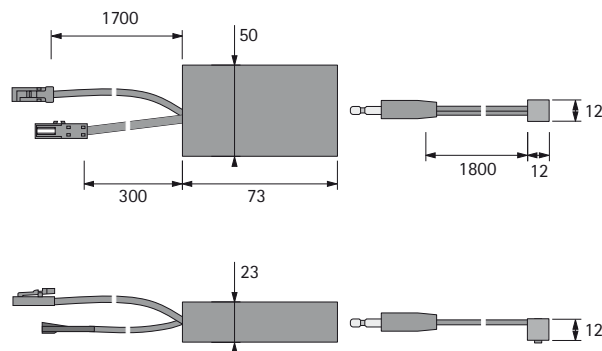

- Switch systems
- Mains-voltage switch

Recessed rocker switch for LED



Plug connection 2 x 1800 mm with LED mini plug connection M1
 Switching voltage 12 Volt DC
 Amperage 3 A max

Order No.	PU
9 100 519	1 each

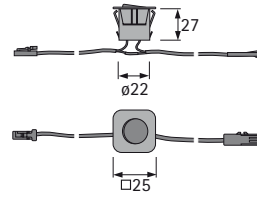

Ballasts



12 Volt DC
Page 78
LED ballasts



12 Volt DC
Page 79
Extension leads and distributors



24 Volt DC
Page 80
LED ballasts



24 Volt DC
Page 81
Extension leads and distributors



350 mA
Page 82
LED ballasts



350 mA
Page 83
Extension leads and distributors







- ▶ LED ballasts
- ▶ 12 Volt DC

LED ballast 1,5 - 15 W



Primary 230 – 240 Volt AC with 2000 mm supply lead
Secondary 12 Volt DC
3 x 45 mm supply lead with LED mini plug connection system M1

Loading capacity 1.5 W min., 15 W max.

Test marks and symbols       SELV

Order No.	PU
9 098 453	1 each

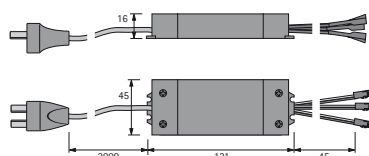







LED ballast 30 W



Primary 230 – 240 Volt AC with 2000 mm supply lead
Secondary 12 Volt DC
2000 mm supply lead, 6-way distributor with LED mini plug connection system M1

Loading capacity 2 W min., 30 W max.

Test marks and symbols       SELV

Order No.	PU
9 138 076	1 each

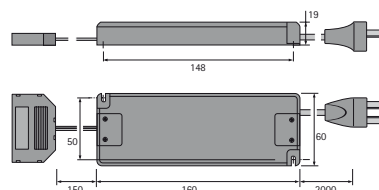

- ▶ Extension leads and distributors
- ▶ 12 Volt DC

LED extension lead M1



Voltage 12 Volt DC
Amperage 3 A max.

Length	Order No.	PU
1800 mm	0 041 762	1 each
5000 mm	0 041 763	1 each

LED M1 6-way distributor



Voltage 12 Volt DC
Amperage 8 A max.
Length 2000 mm

Order No.	PU
9 084 272	1 each

- LED ballast 75 W with mains-voltage plug conn.

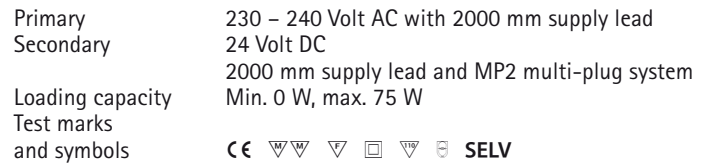

- Extension leads and distributors
- 24 Volt DC

LED MP2 extension lead



Voltage 24 Volt DC
Amperage 8 A max.
Length 1800 mm

Order No.	PU
9 128 294	1 each

2-way LED distributor MP2



Voltage 24 Volt DC
Amperage 8 A max.

Order No.	PU
9 129 453	1 each

6-way LED distributor MP2



Voltage 24 Volt DC
Amperage 8 A max.

Order No.	PU
9 129 455	1 each







- ▶ LED ballasts
- ▶ 350 mA

LED ballast 12 W



Primary 230 – 240 Volt AC with 2000 mm supply lead
 Secondary 350 mA
 150 mm supply lead and LED mini plug connection system M2

Loading capacity 1 W min., 12 W max.

Test marks and symbols     **SELV**  

Order No.	PU
9 138 077	1 each

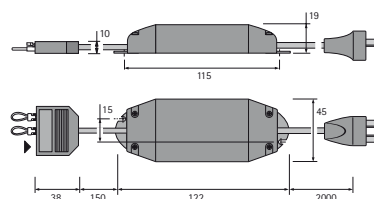

- Extension leads and distributors
- 350 mA

LED M2 extension lead



Amperage
Length

350 mA – 700 mA
1800 mm

Order No.	PU
9 130 680	1 each

3-way LED M2 distributor



Amperage
Length

350 mA – 700 mA
180 mm

Order No.	PU
0 043 877	1 each

Plug connection systems

Pic	Short	Name		Colour	Power supply	max. current	Drill hole diameter
	M1	LED miniature plug system M1 (socket)		black	12 V DC	3 A max.	8 mm
	M1	LED miniature plug system M1 (plug)		black	12 V DC	3 A max.	8 mm
	M2	LED miniature plug system M2 (socket)		white	350 mA	3 A max.	8 mm
	M2	LED miniature plug system M2 (plug)		white	350 mA	3 A max.	8 mm
	MP2	LED multi plug system MP2 (plug and socket)		blue	24 V DC	8 A max.	8 mm



ENEC
European test mark: Confirmation by national certification bodies that electrical products comply with standards.



Safety class 3 – Devices using safety extra-low voltages
Equipment in which protection against electric shock is based on the use of safety extra-low voltage and in which no voltage higher than the safety extra-low voltage is produced.



VDE-GS mark
German test mark for appliances as technical work devices within the meaning of equipment safety law (Gerätesicherheitsgesetz – GSG)



Low-pressure system
Halogen lamps may be operated in an open fixture without a glass cover.



EMV
Test mark from VDE confirming compliance with the law on electromagnetic compatibility



UV Stop
UV radiation falls distinctly below the most stringent limit values for UV protection (NIOSH). Reduction of UV bleaching effect by up to 80 %.



CE
The CE label, for example, indicates confirmation by the manufacturer or importer that a product complies with the Low-Voltage Directive and EMC Directive.

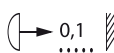

Distance to illuminated surface
The distance to the illuminated surface stated on the lights must always be observed as the minimum distance.



F mark
Lights suitable for direct mounting on or against normal inflammable surfaces carry the F mark. Normally inflammable under DIN 4102 means that the material starts to burn at 180°C.

IP-Codes

Protection against foreign objects / Water

IP 20

Protection against medium-sized foreign objects / no protection against water

IP 21

Protection against medium-sized foreign objects / protection against dripping water

IP 40

Protection against granular foreign objects / no protection against water

IP 44

Protection against granular foreign objects / protection against splashing water from all directions

IP 65

No ingress of dust / protection against water jets



MM mark
Lights and transformers suitable for installing in or on furniture which are made from materials with unknown flammability properties



Temperature-protected electronic transformer
Transformer with temperature protection. The value in the triangle shows the max. housing temperature in the event of a defect.



Short-circuit-proof safety transformer



Independent electronic transformer
For use outside lights without additional cover



Maximum permissible ambient temperature
This is the temperature level up to which no components are thermally overloaded.



C-Tick
C-Tick is a compliance mark for items that must comply with the EMC (Electro Magnetic Compatibility) regulatory arrangements of Australia and New Zealand.

$t_{a_{max}}$

t_c°

Temperature reference point
Denotes the temperature reference point on the housing surface which, if exceeded, reduces useful life.

SELV

Safety extra-low voltage



Safety class 1 – Devices with earth conductor connection
Equipment in which protection against electrical shock does not only rely on basic insulation. An additional measure of protection is given by connecting those conductive components to the protective earth conductor in the building wiring that are otherwise capable of assuming hazardous voltages if the basic insulation fails.



Safety class 2 – Devices without earth conductor connection
Equipment in which protection against electrical shock does not rely on basic insulation only but in which additional safety precautions, such as double insulation or reinforced insulation, are provided. There is no facility for connection to protective earth conductors.

All electrical components conform to Australian/ New Zealand standards and are certified to be used in both countries.

Casting light on light

Lux, lumen and Kelvin; warm, cool and neutral white: although the terminology of lighting technology is all around us, it is not always transparent. We'd like to bring light into the dark with a few explanations.

Light colour and colour temperature

White light consists of the entire colour spectrum; that is to say, it is the sum of all light colours. If the proportion of red in the light dominates the light appears warm, and cooler if it contains more blue. This colour impression that a light source gives us is called the light colour. Colour temperature is measured in Kelvin (K). This only provides information on the visual colour impression; it does not say anything about the thermal value of the light.

Classes

Warm white	2700 – 3300 K	cosy, calming
Neutral white	4000 – 4500 K	sober
Cool white	5000 – 6500 K	like daylight, technical, stimulating

Colour names are not standardised and do not refer to any specific light colours, only to colour ranges.

Colour reproduction

Light that contains all the spectral colours – such as daylight – makes the colours of objects look natural. Colour reproduction is neutral, and therefore particularly favourable for judging colours. The colours of objects tend to look unnatural in light with an unbalanced colour spectrum. The quality of the colour reproduction given by a light source is assessed by the colour rendering index (RA). The best value for neutral, natural colour reproduction is $RA = 100$.

Luminous flux

Luminous flux describes the luminous efficiency of a light source and is expressed in lumen (Lm).

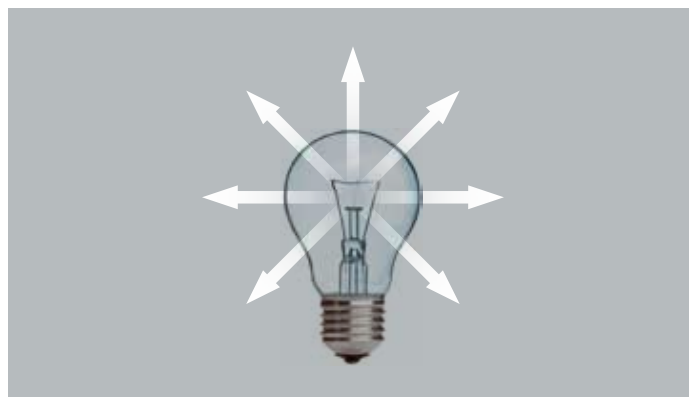

Luminous intensity

Light intensity (illuminance) is probably the term most frequently used in lighting and defines the incidence of luminous flux on a defined surface, measured in lux (Lx).

$$\text{Lux} = \text{lumen/m}^2$$

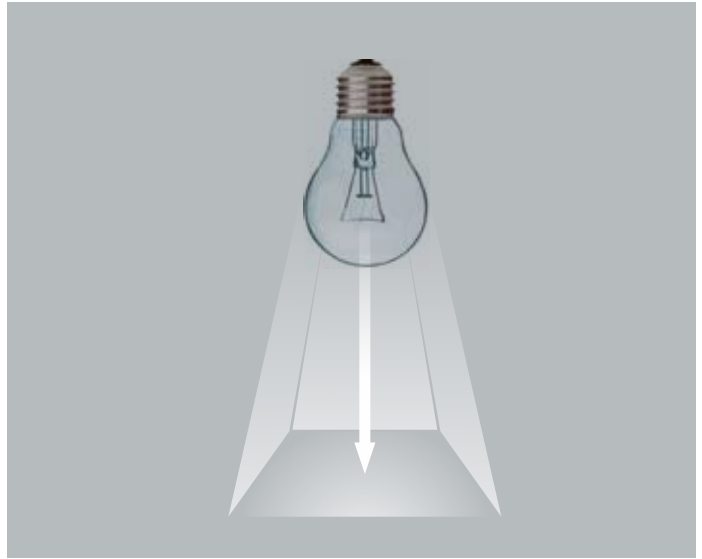

Light distribution diagrams

The light distribution diagrams shown in the catalogue help to choose the right light.

The graphs demonstrate:

1. light intensity in relation to distance from light
2. area over which light is distributed
3. radiation angle (half peak angle)

The lux values shown were measured in a black room.

Luminous intensity guide values (DIN 5035, Part 2)

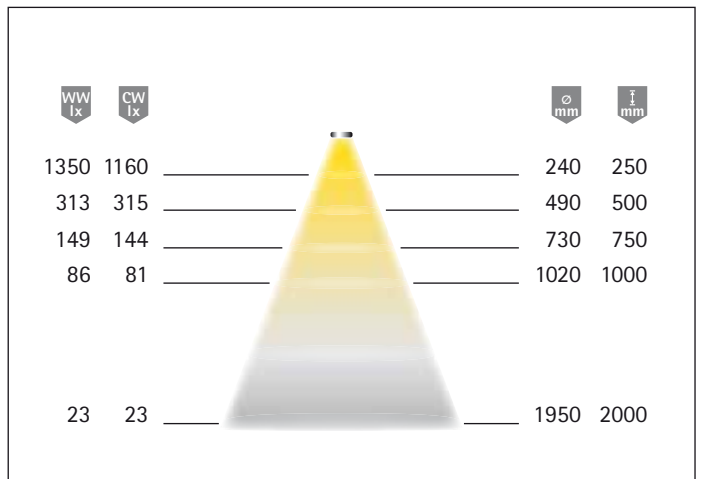

Luminous intensity	Purpose of space or type of activity		
1000 Lux	Colour inspection, colour checks, goods inspection Assembly of precision equipment (electrical/electronic) Jewellery making, retouching etc.	Task lighting	High level of illumination
750 Lux	Technical drawing Drawing and error-checking stations Selecting wood veneers Grinding, polishing glass, precision assembly		
500 Lux	Office spaces, data processing, conference rooms Exhibition stands, control platforms Store payment points		
300 Lux	Offices with workstations only in window proximity Lathing, drilling, milling, medium-precision assembly Shops, dispatch departments	Mood lighting	mid-level illumination
200 Lux	Archives, store rooms with reading activity Rough assembly work Office spaces frequented by the public Changing rooms, washrooms and WCs		
100 Lux	Storerooms Vehicle and pedestrian traffic in buildings Foyers, stairwells and escalators	Orientation lighting	low-level of illumination

Subject index

A			L			T		
Accessories LED-lights 12 Volt DC	79		LED dimmer	70–71		Tri-Mitter wireless switch	72	
Accessories LED-lights 24 Volt DC	81		LED GlasLine	58				
Accessories LED-lights 350 mA	83		LED door-contact switch with sensor	75		V		
			LooLite	28		Versa	44	
B			LuckyInside	38		Versa Inside I	46	
Ballasts 12 Volt	78					Versa Inside II	48	
Ballasts 24 Volt	80		M			Versa Inside MultiColor	50	
Ballasts 350 mA	82		MiniSwitch no-touch LED sensor switch	74		Versa SideView	52	
BriteLine	26							
BriteSquare L	34		N					
			No-touch LED sensor switch	73				
C			R					
ChannelLine 1–2	54		Race	24				
ChannelLine 3–6	55, 56		Recessed rocker switch for LED	76				
ChannelLine 7, 8 & 10	57							
E			S					
EcoPower	36		Sign round	32				
			Spot in Plus	62				
F			StarPoint	60				
FixPoint	66		StarPoint mini	64				
			SuperNovara	22				
I			Swing	30				
InnoLine	40							

Product index

Product no.	Page	Product no.	Page	Product no.	Page	Product no.	Page	Product no.	Page	Product no.	Page
040 163	50	9 084 272	58	9 128 490	36	9 138 076	52				
040 164	50	9 084 272	60	9 128 491	36	9 138 076	78				
041 762	20	9 084 272	64	9 128 496	62	9 138 077	28				
041 762	22	9 084 272	66	9 128 501	62	9 138 077	62				
041 762	24	9 084 272	79	9 128 502	62	9 138 077	82				
041 762	26	9 086 850	24	9 128 507	74	9 138 633	36				
041 762	30	9 086 851	24	9 128 509	46	9 138 634	36				
041 762	32	9 098 453	24	9 128 510	46	9 138 635	62				
041 762	34	9 098 453	26	9 128 511	46	9 138 636	62				
041 762	36	9 098 453	30	9 128 512	46	9 139 151	28				
041 762	40	9 098 453	32	9 128 513	46						
041 762	44	9 098 453	34	9 128 514	46						
041 762	52	9 098 453	36	9 128 515	46						
041 762	58	9 098 453	40	9 128 516	50						
041 762	60	9 098 453	44	9 128 517	50						
041 762	64	9 098 453	58	9 128 518	50						
041 762	66	9 098 453	60	9 128 519	50						
041 762	79	9 098 453	64	9 128 520	48						
041 763	79	9 098 453	66	9 128 521	48						
043 877	28	9 098 453	78	9 128 522	48						
043 877	83	9 100 519	76	9 128 523	48						
1 160 131	32	9 106 400	54	9 128 524	48						
1 160 132	32	9 116 710	54	9 128 525	48						
9 069 840	44	9 117 062	55	9 128 526	48						
9 069 964	44	9 117 063	56	9 128 527	52						
9 069 968	44	9 117 064	56	9 128 528	52						
9 069 973	44	9 117 065	57	9 128 529	52						
9 069 976	44	9 117 067	55	9 128 530	52						
9 070 181	24	9 117 068	55	9 129 046	30						
9 070 251	70	9 117 069	56	9 129 060	58						
9 070 584	40	9 117 070	56	9 129 088	50						
9 070 587	40	9 117 071	57	9 129 440	28						
9 070 597	73	9 117 386	54	9 129 453	46						
9 070 599	75	9 117 387	55	9 129 453	48						
9 070 695	66	9 127 512	38	9 129 453	81						
9 070 696	24	9 127 514	72	9 129 455	46						
9 070 703	32	9 127 515	72	9 129 455	48						
9 070 705	32	9 127 517	30	9 129 455	81						
9 070 820	64	9 127 531	20	9 129 456	57						
9 070 822	60	9 127 532	20	9 129 459	57						
9 070 843	64	9 127 539	71	9 129 483	28						
9 070 845	64	9 128 054	58	9 129 490	22						
9 070 847	60	9 128 057	58	9 129 491	22						
9 071 730	40	9 128 058	58	9 129 499	57						
9 071 802	44	9 128 088	66	9 129 502	57						
9 084 224	32	9 128 294	46	9 130 680	62						
9 084 267	54	9 128 294	48	9 130 680	83						
9 084 272	22	9 128 294	81	9 130 680	28						
9 084 272	24	9 128 396	26	9 138 075	46						
9 084 272	26	9 128 397	26	9 138 075	48						
9 084 272	30	9 128 398	26	9 138 075	50						
9 084 272	32	9 128 399	26	9 138 075	80						
9 084 272	34	9 128 400	26	9 138 076	20						
9 084 272	36	9 128 481	26	9 138 076	22						
9 084 272	40	9 128 486	34	9 138 076	26						
9 084 272	44	9 128 487	34	9 138 076	44						

All lights, transformers/ballasts, cables, switches and accessories in this catalogue are approved and comply to the relevant Australian/New Zealand standards and regulations. If the fitter or third parties modify the "magic" light of transformer systems with respect to the condition in which they are supplied (this applies particularly to any modifications of the cables), we undertake no guarantee or liability for consequential damage. Colour differences occur in the production of LEDs for manufacturing reasons and reflect the state of the art.

hettich.com.au
hettich.co.nz

Australia



New Zealand



9 139 356

Technik für Möbel

Hettich